

CITY OF CARROLLTON BENCHMARK CATALOG

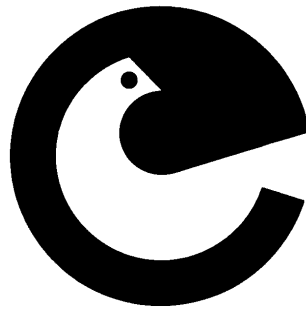

CARROLLTON

Department of Public Works

JANUARY, 2003

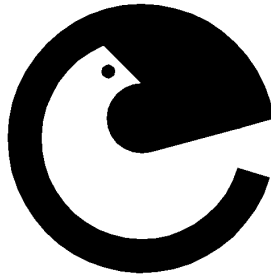

CATALOG OF LOCAL BENCHMARKS

The City of Carrollton Ordinance 1227 requires that all plats, with the exception of *Amending* and *Vacation* plats (as defined in the City's Subdivision Ordinance) be rectified to the State Plane Coordinate System, North Central Texas Zone 4202. In order to assist with this requirement, the City is providing information on benchmarks.

This catalog contains 41 benchmarks. All are second-order monuments. Benchmarks COC 1 through COC 26 were set and/or verified by TxDOT, in Oct. 2002, for the City of Carrollton. The remaining 15 were existing TxDOT benchmarks. They have been included due to their proximity to the City of Carrollton.

UPDATED AUGUST 20, 2010

Benchmarks COC-1, COC-4, COC-11, COC-14 and COC-25 no longer exist.

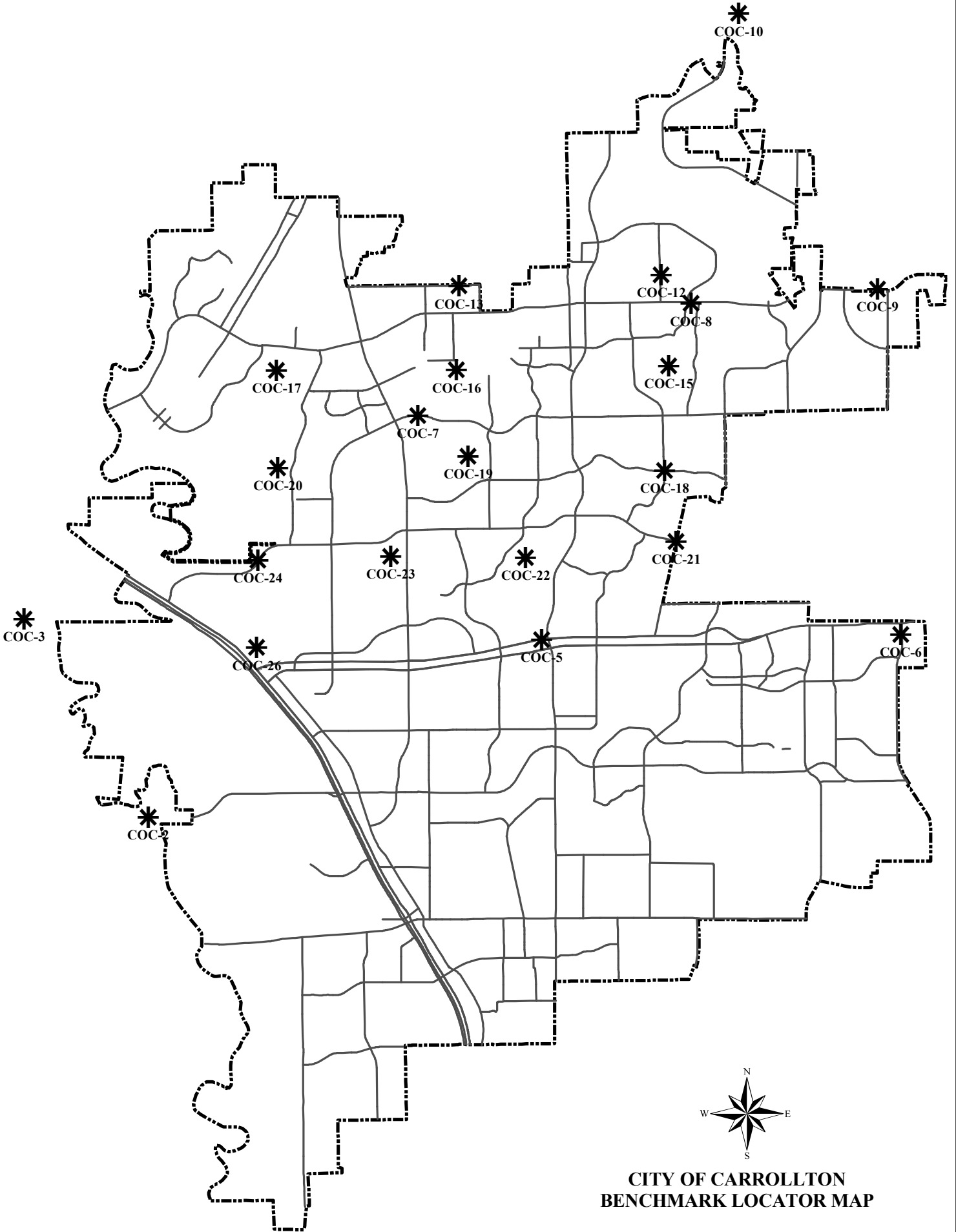

**CITY OF CARROLLTON
BENCHMARK LOCATOR MAP**

**TEXAS DEPARTMENT OF TRANSPORTATION
GPS SATELLITE STATION
HORIZONTAL - VERTICAL CONTROL DATA
UNITS US SURVEY FEET**

STATION INFORMATION

NAME OF STATION: COC 2
SURVEYED FROM: DALLAS RRP, ARLINGTON RRP
DATE: OCT. 21, 2002
LOCALITY: SANDY LAKE RD. AND CITY LIMITS COPPELL
COUNTY: DALLAS

STATE PLANE COORDINATES	ORTHO ELEVATION	ADJ. FACTOR SURFACE	TEXAS ZONE
N: 7037935.799 E: 2445117.820	Z: 448.836	1.000136506	4202

LATITUDE	LONGITUDE	ELLIP. HEIGHT
32°57'57.92077"N	96°56'45.01380"W	E.H. 360.891

DESCRIPTION OF SATELLITE STATION

STATION IS A ROUND 2" BRASS DISK SET IN CONCRETE ON TOP OF A CURB INLET AND IS STAMPED COC-2

DISCLAIMER: USING THE VERTICAL DATA IS AT YOUR OWN RISK. SHOULD BE FIELD VERIFIED.

THIS GPS CONTROL POINT IS ON DALLAS MAPSCO PAGE 1B-Y. THE STATION IS LOCATED 930' EAST OF THE INTERSECTION OF SANDY LAKE ROAD AND RIVERVIEW DRIVE IN COPPELL. STATION IS 32' NORTH OF THE CENTERLINE OF SANDY LAKE ROAD.

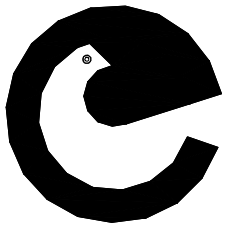
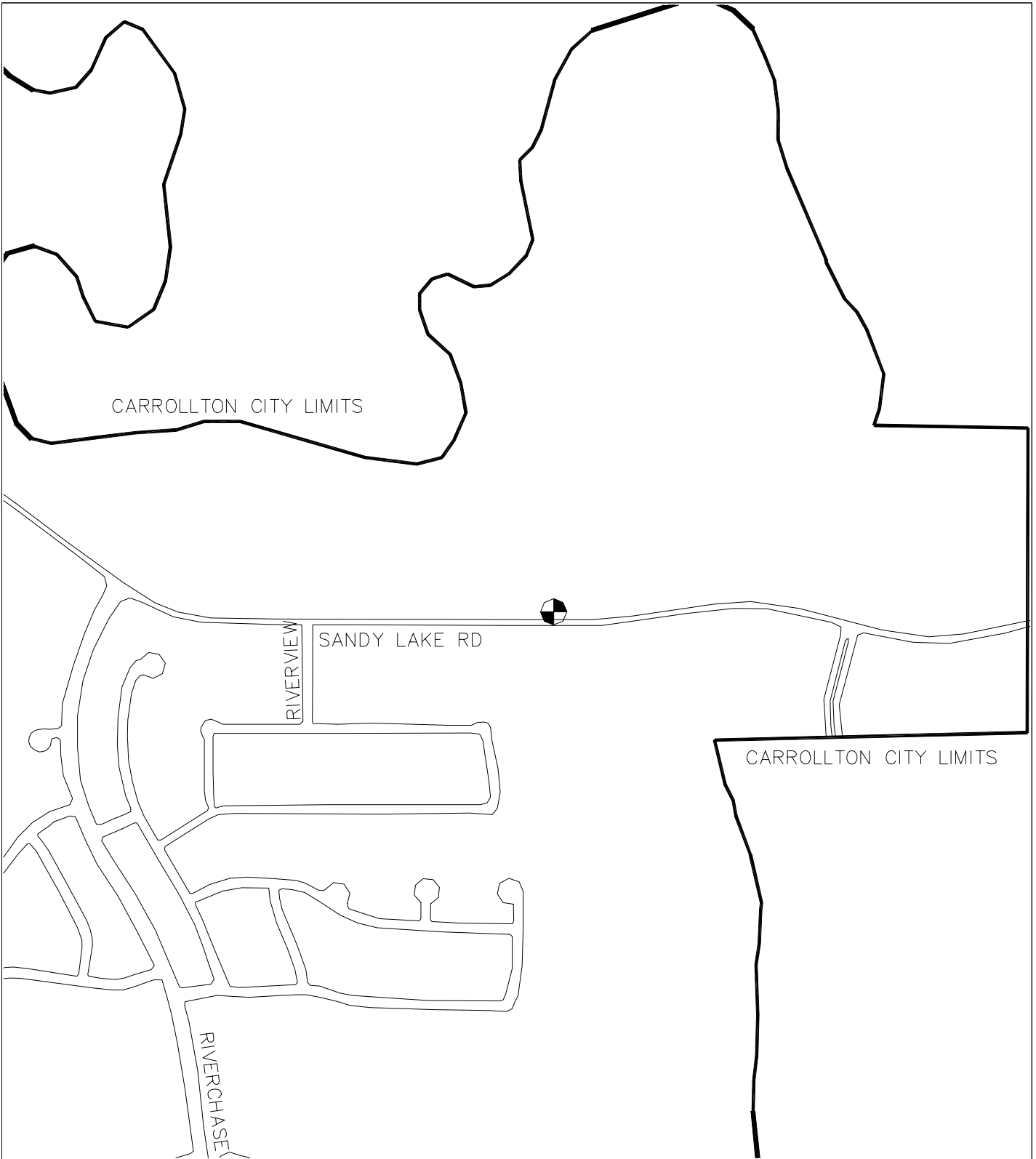

BENCHMARK COC 2
NORTHING 7037935.799
EASTING 2445117.820
ELEVATION 448.836

SCALE: N.T.S.
DATE:
SHEET: 1 OF 1

PUBLIC WORKS
DEPARTMENT

**TEXAS DEPARTMENT OF TRANSPORTATION
GPS SATELLITE STATION
HORIZONTAL - VERTICAL CONTROL DATA
UNITS US SURVEY FEET**

STATION INFORMATION

NAME OF STATION: COC 3
SURVEYED FROM: DALLAS RRP, ARLINGTON RRP
DATE: OCT. 21, 2002
LOCALITY: LAKE VISTA DRIVE
COUNTY: DENTON

STATE PLANE COORDINATES	ORTHO ELEVATION	ADJ. FACTOR SURFACE	TEXAS ZONE
N: 7046282.754 E: 2439894.844	Z: 448.095	1.000136506	4202

LATITUDE	LONGITUDE	ELLIP. HEIGHT
32°59'21.26733"N	96°57'44.88321"W	E.H. 360.054

DESCRIPTION OF SATELLITE STATION

STATION IS A ROUND 2" BRASS DISK SET IN CONCRETE ON TOP OF A CURB INLET AND IS STAMPED COC-3

DISCLAIMER: USING THE VERTICAL DATA IS AT YOUR OWN RISK. SHOULD BE FIELD VERIFIED.

THIS GPS CONTROL POINT IS ON DALLAS MAPSCO PAGE 1B-J. THE STATION IS LOCATED WEST OF THE INTERSECTION OF LAKE VISTA DRIVE AND THE ENTRANCE TO VISTA RIDGE DRIVE ATHLETIC COMPLEX; STATION IS 0.2 MILES WEST FROM THIS INTERSECTION. STATION IS 66' SOUTH OF A POWER POLE NUMBER 19 AND 69' SOUTHEAST OF A FIRE HYDRANT. STATION IS 28' SOUTH OF THE CENTERLINE OF LAKE VISTA DRIVE.

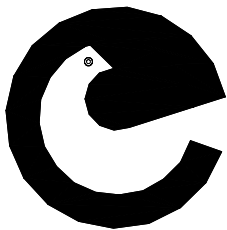
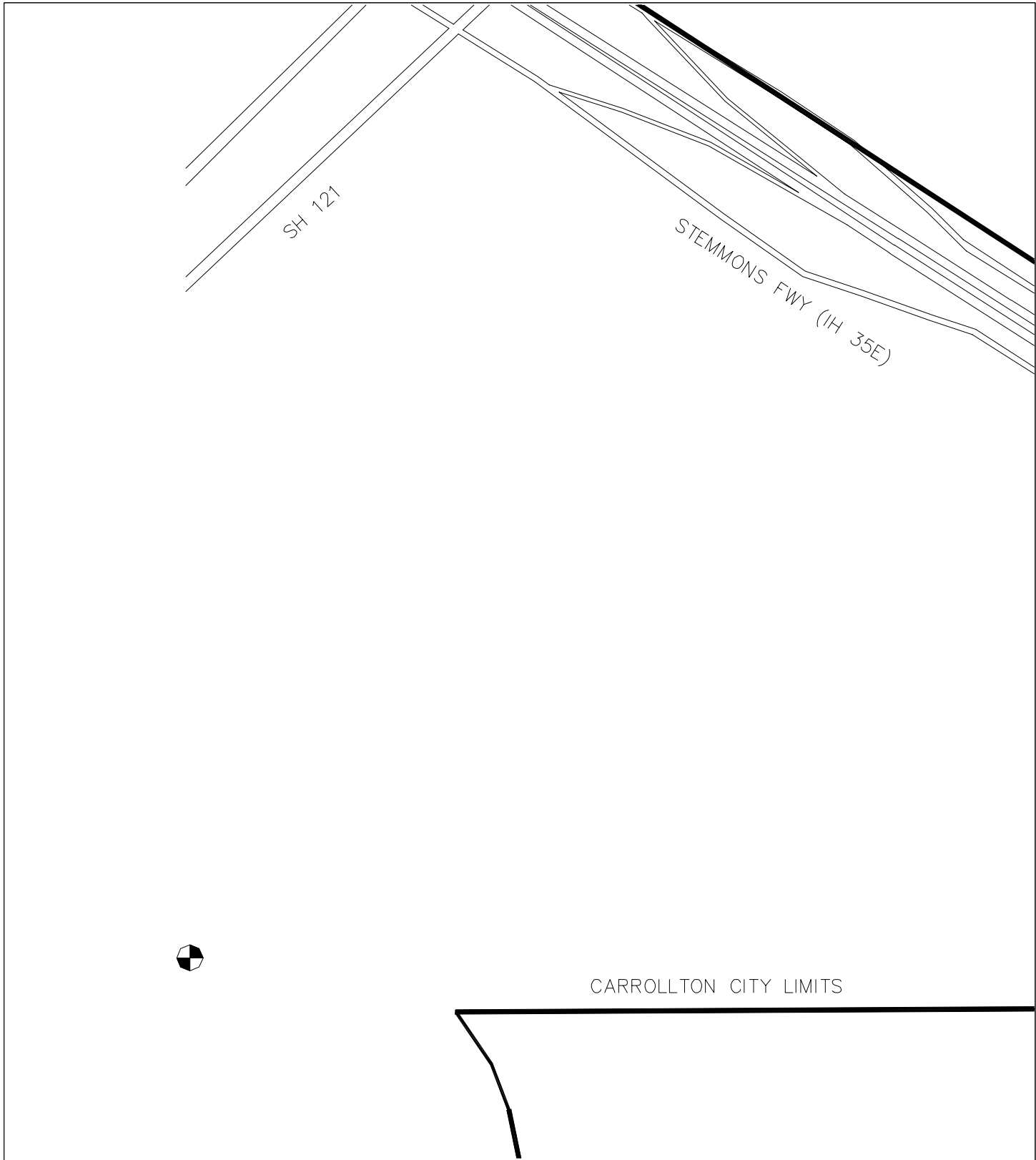

BENCHMARK COC 3
NORTHING 7046282.754
EASTING 2439894.844
ELEVATION 448.095

SCALE: N.T.S.
DATE:
SHEET: 1 OF 1

PUBLIC WORKS
DEPARTMENT

**TEXAS DEPARTMENT OF TRANSPORTATION
GPS SATELLITE STATION
HORIZONTAL - VERTICAL CONTROL DATA
UNITS US SURVEY FEET**

STATION INFORMATION

**NAME OF STATION: COC 5
SURVEYED FROM: DALLAS RRP, ARLINGTON RRP
DATE: OCT. 21, 2002
LOCALITY: TRINITY MILLS ROAD AND JOSEY LANE
COUNTY: DALLAS**

STATE PLANE COORDINATES	ORTHO ELEVATION	ADJ. FACTOR SURFACE	TEXAS ZONE
N: 7045423.518 E: 2461658.494	Z: 510.943	1.000136506	4202

LATITUDE	LONGITUDE	ELLIP. HEIGHT
32°59'09.54150"N	96°53'29.52801"W	E.H. 423.667

DESCRIPTION OF SATELLITE STATION

STATION IS A ROUND 2" BRASS DISK SET IN CONCRETE ON TOP OF A CURB INLET AND IS STAMPED COC-5

DISCLAIMER: USING THE VERTICAL DATA IS AT YOUR OWN RISK. SHOULD BE FIELD VERIFIED.

THIS GPS CONTROL POINT IS ON DALLAS MAPSCO PAGE 3-J. THE STATION IS LOCATED WEST OF THE INTERSECTION OF TRINITY MILLS ROAD AND JOSEY LANE. STATION IS 250' WEST OF THE CENTERLINE OF JOSEY LANE. STATION IS SET IN TOP OF AN INLET ON NORTH CURBLINE.

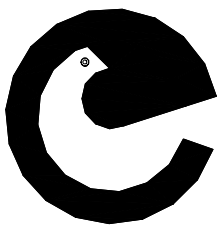
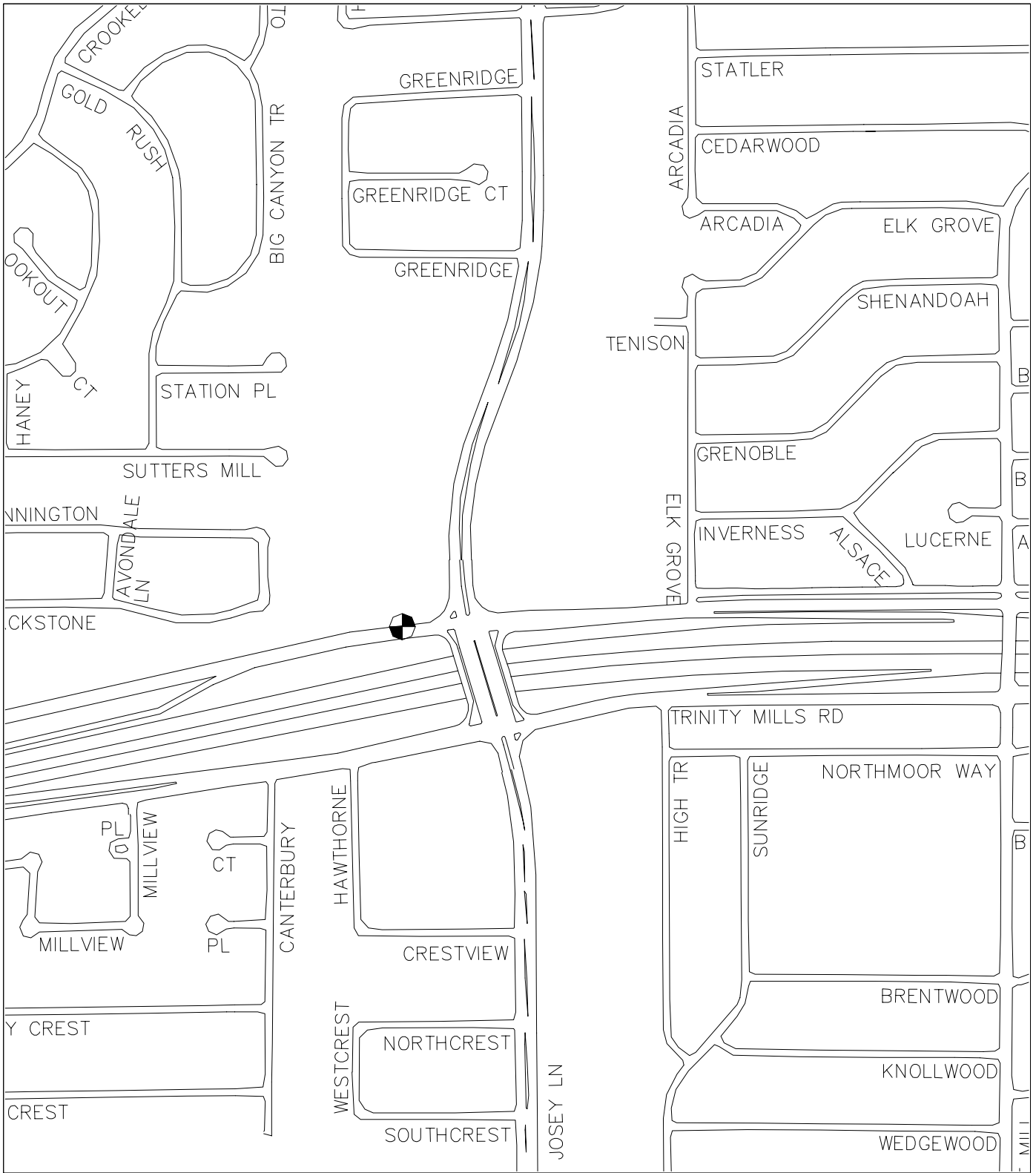

BENCHMARK COC 5
NORTHING 7045423.518
EASTING 2461658.494
ELEVATION 510.943

SCALE: N.T.S.
 DATE:
 SHEET: 1 OF 1

PUBLIC WORKS
 DEPARTMENT

**TEXAS DEPARTMENT OF TRANSPORTATION
GPS SATELLITE STATION
HORIZONTAL - VERTICAL CONTROL DATA
UNITS US SURVEY FEET**

STATION INFORMATION

NAME OF STATION: COC 6
SURVEYED FROM: DALLAS RRP, ARLINGTON RRP
DATE: OCT. 21, 2002
LOCALITY: TRINITY MILLS ROAD AND MIDWAY RD.
COUNTY: DALLAS

STATE PLANE COORDINATES N: 7045627.438 E: 2476759.519	ORTHO ELEVATION Z: 664.710	ADJ. FACTOR SURFACE 1.000136506	TEXAS ZONE 4202
--	--	---	-----------------------------------

LATITUDE 32°59'09.23628"N	LONGITUDE 96°50'32.20897"W	ELLIP. HEIGHT E.H. 578.017
-------------------------------------	--------------------------------------	--------------------------------------

DESCRIPTION OF SATELLITE STATION

STATION IS A ROUND 2" BRASS DISK SET IN CONCRETE ON TOP OF A CURB INLET AND IS STAMPED COC-6

DISCLAIMER: USING THE VERTICAL DATA IS AT YOUR OWN RISK. SHOULD BE FIELD VERIFIED.

THIS GPS CONTROL POINT IS ON DALLAS MAPSCO PAGE 4-K. THE STATION IS LOCATED SOUTH OF THE INTERSECTION OF TRINITY MILLS ROAD AND MIDWAY ROAD. STATION IS 520' SOUTH OF TRINITY MILLS ROAD. STATION IS 42' WEST OF THE CENTERLINE OF MIDWAY ROAD AND 70' NORTH OF A CONCRETE DRIVE ON THE WEST CURBLINE.

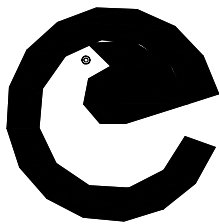
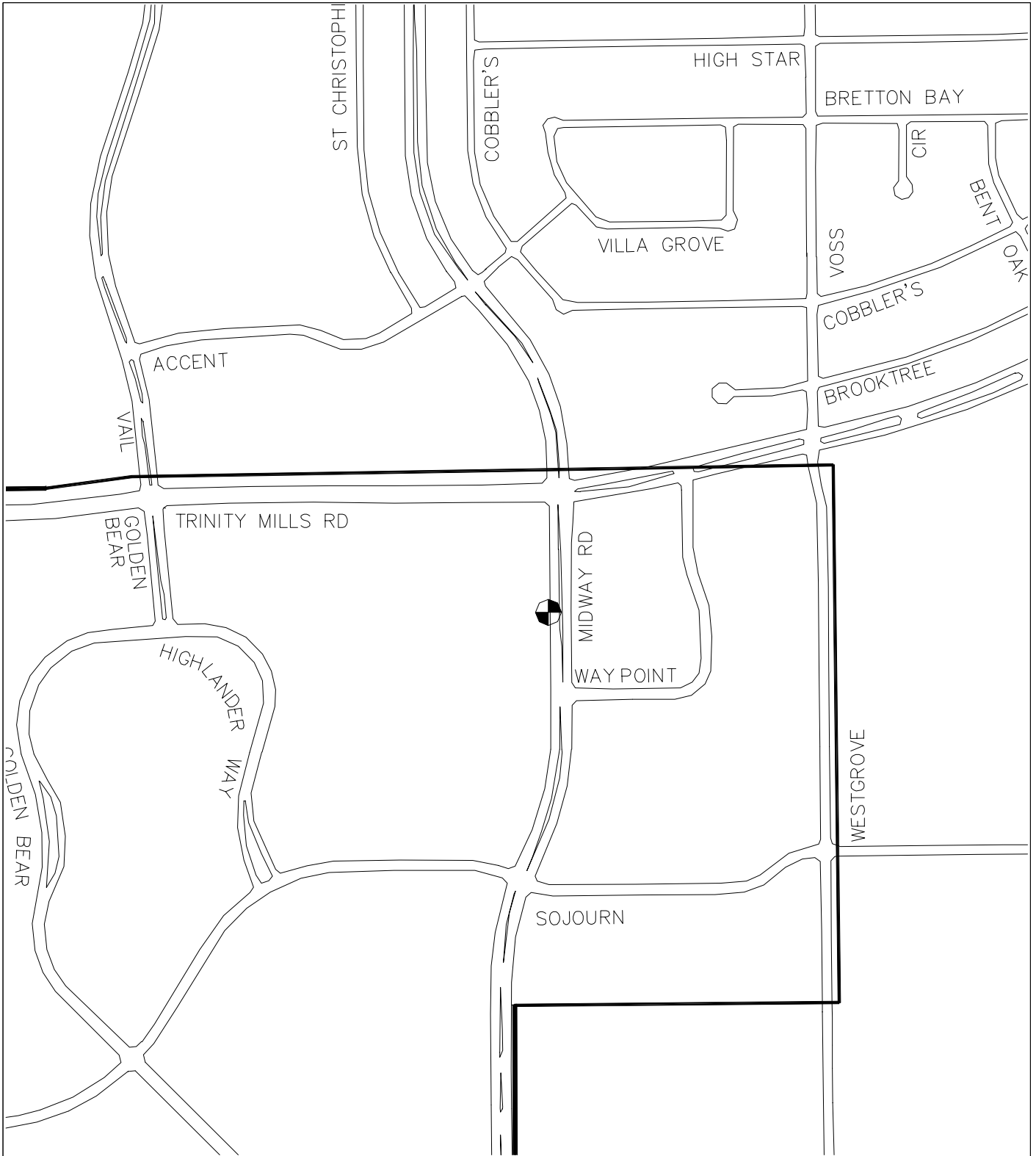

BENCHMARK COC 6
NORTHING 7045627.438
EASTING 2476759.519
ELEVATION 664.71

SCALE: N.T.S.
 DATE:
 SHEET: 1 OF 1

PUBLIC WORKS
 DEPARTMENT

**TEXAS DEPARTMENT OF TRANSPORTATION
GPS SATELLITE STATION
HORIZONTAL - VERTICAL CONTROL DATA
UNITS US SURVEY FEET**

STATION INFORMATION

NAME OF STATION: COC 7
SURVEYED FROM: DALLAS RRP, ARLINGTON RRP
DATE: OCT. 21, 2002
LOCALITY: ROSEMEADE PKWY. AND MUIRFIELD
COUNTY: DENTON

STATE PLANE COORDINATES	ORTHO ELEVATION	ADJ. FACTOR SURFACE	TEXAS ZONE
N: 7054855.665 E: 2456449.638	Z: 484.547	1.000136506	4202

LATITUDE	LONGITUDE	ELLIP. HEIGHT
33°00'43.64872"N	96°54'29.00082"W	E.H. 397.178

DESCRIPTION OF SATELLITE STATION

STATION IS A ROUND 2" BRASS DISK SET IN CONCRETE ON TOP OF A CURB INLET AND IS STAMPED COC-7

DISCLAIMER: USING THE VERTICAL DATA IS AT YOUR OWN RISK. SHOULD BE FIELD VERIFIED.

THIS GPS CONTROL POINT IS ON DALLAS MAPSCO PAGE 653-Y. THE STATION IS LOCATED EAST OF THE INTERSECTION OF ROSEMEADE PARKWAY AND MUIRFIELD DRIVE. STATION IS 150' EAST OF MUIRFIELD DRIVE AND 48' FEET NORTH OF THE CENTERLINE OF ROSEMEADE PARKWAY. STATION IS 45' SOUTHEAST OF A POWER POLE.

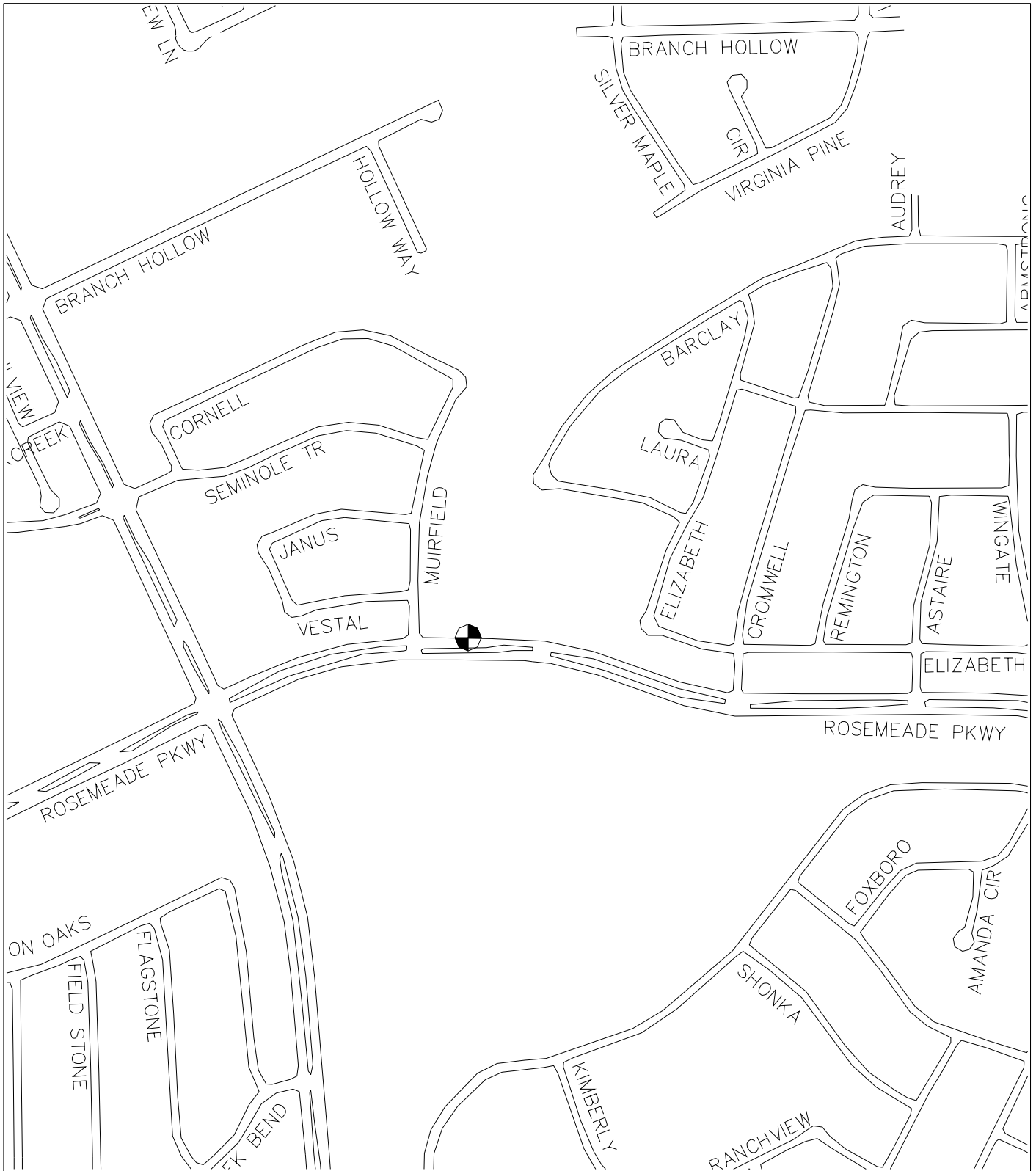

BENCHMARK COC 7
NORTHING 7054855.665
EASTING 2456449.638
ELEVATION 484.547

SCALE: N.T.S.
 DATE:
 SHEET: 1 OF 1

PUBLIC WORKS
 DEPARTMENT

**TEXAS DEPARTMENT OF TRANSPORTATION
GPS SATELLITE STATION
HORIZONTAL - VERTICAL CONTROL DATA
UNITS US SURVEY FEET**

STATION INFORMATION

NAME OF STATION: COC 8
SURVEYED FROM: DALLAS RRP, ARLINGTON RRP
DATE: OCT. 21, 2002
LOCALITY: HEBRON PKWY. AND ARBOR CREEK DR.
COUNTY: DENTON

STATE PLANE COORDINATES	ORTHO ELEVATION	ADJ. FACTOR SURFACE	TEXAS ZONE
N: 7059561.662 E: 2467941.840	Z: 553.130	1.000136506	4202

LATITUDE	LONGITUDE	ELLIP. HEIGHT
33°01'28.46631"N	96°52'13.18823"W	E.H. 466.257

DESCRIPTION OF SATELLITE STATION

STATION IS A ROUND 2" BRASS DISK SET IN CONCRETE ON TOP OF A CURB INLET AND IS STAMPED COC-8

DISCLAIMER: USING THE VERTICAL DATA IS AT YOUR OWN RISK. SHOULD BE FIELD VERIFIED.

THIS GPS CONTROL POINT IS ON DALLAS MAPSCO PAGE 654-U. THE STATION IS LOCATED EAST OF THE INTERSECTION OF HEBRON PARKWAY AND ARBOR CREEK DRIVE. STATION IS 190' EAST OF THE CENTERLINE OF ARBOR CREEK DRIVE AND 360' WEST OF PROVINCE DRIVE. STATION IS 6' NORTH OF A POWER POLE.

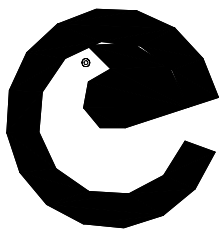
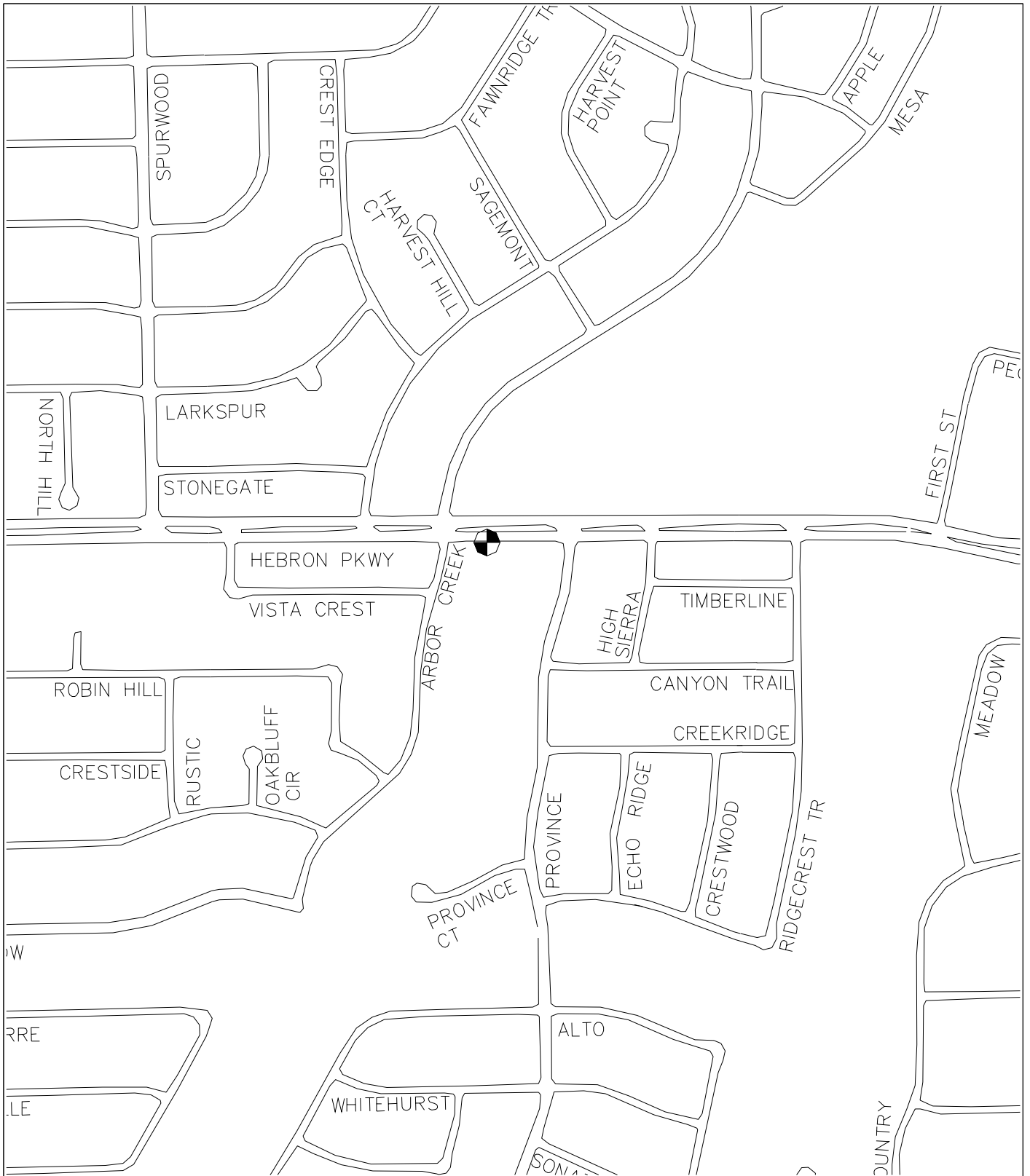

BENCHMARK COC 8
NORTHING 7059561.662
EASTING 2467941.840
ELEVATION 553.130

SCALE: N.T.S.
 DATE:
 SHEET: 1 OF 1

PUBLIC WORKS
 DEPARTMENT

**TEXAS DEPARTMENT OF TRANSPORTATION
GPS SATELLITE STATION
HORIZONTAL - VERTICAL CONTROL DATA
UNITS US SURVEY FEET**

STATION INFORMATION

NAME OF STATION: COC 9
SURVEYED FROM: DALLAS RRP, ARLINGTON RRP
DATE: OCT. 21, 2002
LOCALITY: HEBRON PKWY. AND MIDWAY ROAD
COUNTY: DENTON

STATE PLANE COORDINATES	ORTHO ELEVATION	ADJ. FACTOR SURFACE	TEXAS ZONE
N: 7060164.069 E: 2475777.393	Z: 701.166	1.000136506	4202

LATITUDE	LONGITUDE	ELLIP. HEIGHT
33°01'33.21434"N	96°50'41.04968"W	E.H. 614.603

DESCRIPTION OF SATELLITE STATION

STATION IS A ROUND 2" BRASS DISK SET IN CONCRETE ON TOP OF A CURB INLET AND IS STAMPED COC-9

DISCLAIMER: USING THE VERTICAL DATA IS AT YOUR OWN RISK. SHOULD BE FIELD VERIFIED.

THIS GPS CONTROL POINT IS ON DALLAS MAPSCO PAGE 655-T. THE STATION IS LOCATED WEST OF THE INTERSECTION OF HEBRON PARKWAY AND MIDWAY ROAD. STATION IS 360' WEST OF MIDWAY ROAD AND 110' NORTHEAST OF A POWER POLE #96506-688673 IN THE SOUTH RIGHT OF WAY LINE. STATION IS 60' NORTHEAST OF A LIGHT POLE ON THE MEDIAN OF HEBRON PARKWAY.

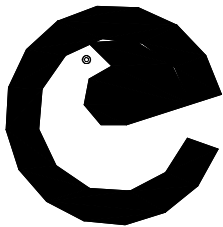
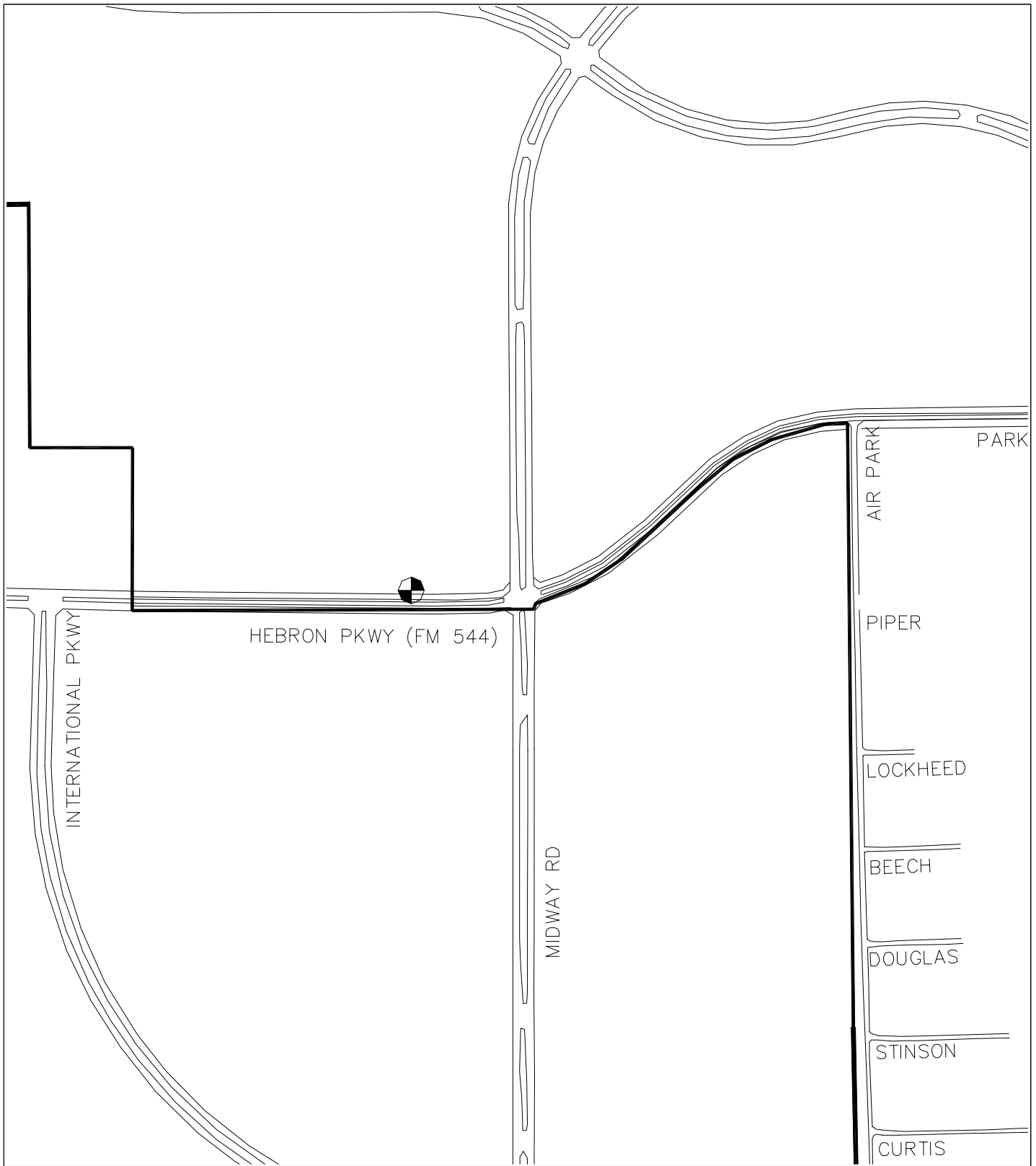

BENCHMARK COC 9
NORTHING 7060164.069
EASTING 2475777.393
ELEVATION 701.166

SCALE: N.T.S.
 DATE:
 SHEET: 1 OF 1

PUBLIC WORKS
 DEPARTMENT

**TEXAS DEPARTMENT OF TRANSPORTATION
GPS SATELLITE STATION
HORIZONTAL - VERTICAL CONTROL DATA
UNITS US SURVEY FEET**

STATION INFORMATION

NAME OF STATION: COC 10
SURVEYED FROM: DALLAS RRP, ARLINGTON RRP
DATE: OCT. 21, 2002
LOCALITY: PLANO PKWY. AND WINDHAVEN PKWY.
COUNTY: DENTON

STATE PLANE COORDINATES	ORTHO ELEVATION	ADJ. FACTOR SURFACE	TEXAS ZONE
N: 7071756.429 E: 2469937.285	Z: 538.112	1.000136506	4202

LATITUDE	LONGITUDE	ELLIP. HEIGHT
33°03'28.81365"N	96°51'47.52033"W	E.H. 451.493

DESCRIPTION OF SATELLITE STATION

STATION IS A ROUND 2" BRASS DISK SET IN CONCRETE ON TOP OF A CURB INLET AND IS STAMPED COC-10

DISCLAIMER: USING THE VERTICAL DATA IS AT YOUR OWN RISK. SHOULD BE FIELD VERIFIED.

THIS GPS CONTROL POINT IS ON DALLAS MAPSCO PAGE 654-C. THE STATION IS LOCATED WEST OF THE INTERSECTION OF PLANO PARKWAY AND WINDHAVEN PARKWAY. STATION IS 190' SOUTH OF WINDHAVEN PARKWAY AND 45' EAST OF THE CENTERLINE OF PLANO PARKWAY. STATION IS 125' NORTHEAST OF A LIGHT POLE ON THE MEDIAN OF PLANO PARKWAY.

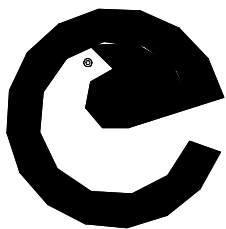
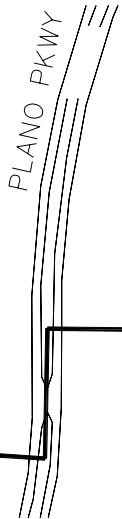

**BENCHMARK COC 10
NORTHING 7071756.429
EASTING 2469937.285
ELEVATION 538.112**

SCALE: N.T.S.
DATE:
SHEET: 1 OF 1

PUBLIC WORKS
DEPARTMENT

**TEXAS DEPARTMENT OF TRANSPORTATION
GPS SATELLITE STATION
HORIZONTAL - VERTICAL CONTROL DATA
UNITS US SURVEY FEET**

STATION INFORMATION

**NAME OF STATION: COC 12
SURVEYED FROM: DALLAS RRP, ARLINGTON RRP
DATE: OCT. 21, 2002
LOCALITY: GREENSTONE TRAIL AND SPURWOOD
COUNTY: DENTON**

STATE PLANE COORDINATES N: 7060756.986 E: 2466677.346	ORTHO ELEVATION Z: 576.269	ADJ. FACTOR SURFACE 1.000136506	TEXAS ZONE 4202
--	--	---	-------------------------------------

LATITUDE 33°01'40.48669"N	LONGITUDE 96°52'27.82232"W	ELLIP. HEIGHT E.H. 489.363
--------------------------------------	---------------------------------------	---------------------------------------

DESCRIPTION OF SATELLITE STATION

STATION IS A ROUND 2" BRASS DISK SET IN A CONCRETE CYLINDER BEHIND THE BACK OF CURB.

DISCLAIMER: USING THE VERTICAL DATA IS AT YOUR OWN RISK. SHOULD BE FIELD VERIFIED.

THIS GPS CONTROL POINT IS ON DALLAS MAPSCO PAGE 654-P. THE STATION IS LOCATED AT THE NORTHEAST CORNER OF THE INTERSECTION OF SPURWOOD DR. AND GREENSTONE TRAIL. STATION IS 3' BEHIND THE NORTH CURB LINE OF GREENSTONE TRAIL.

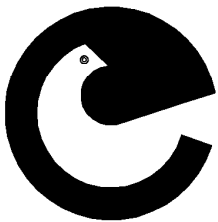
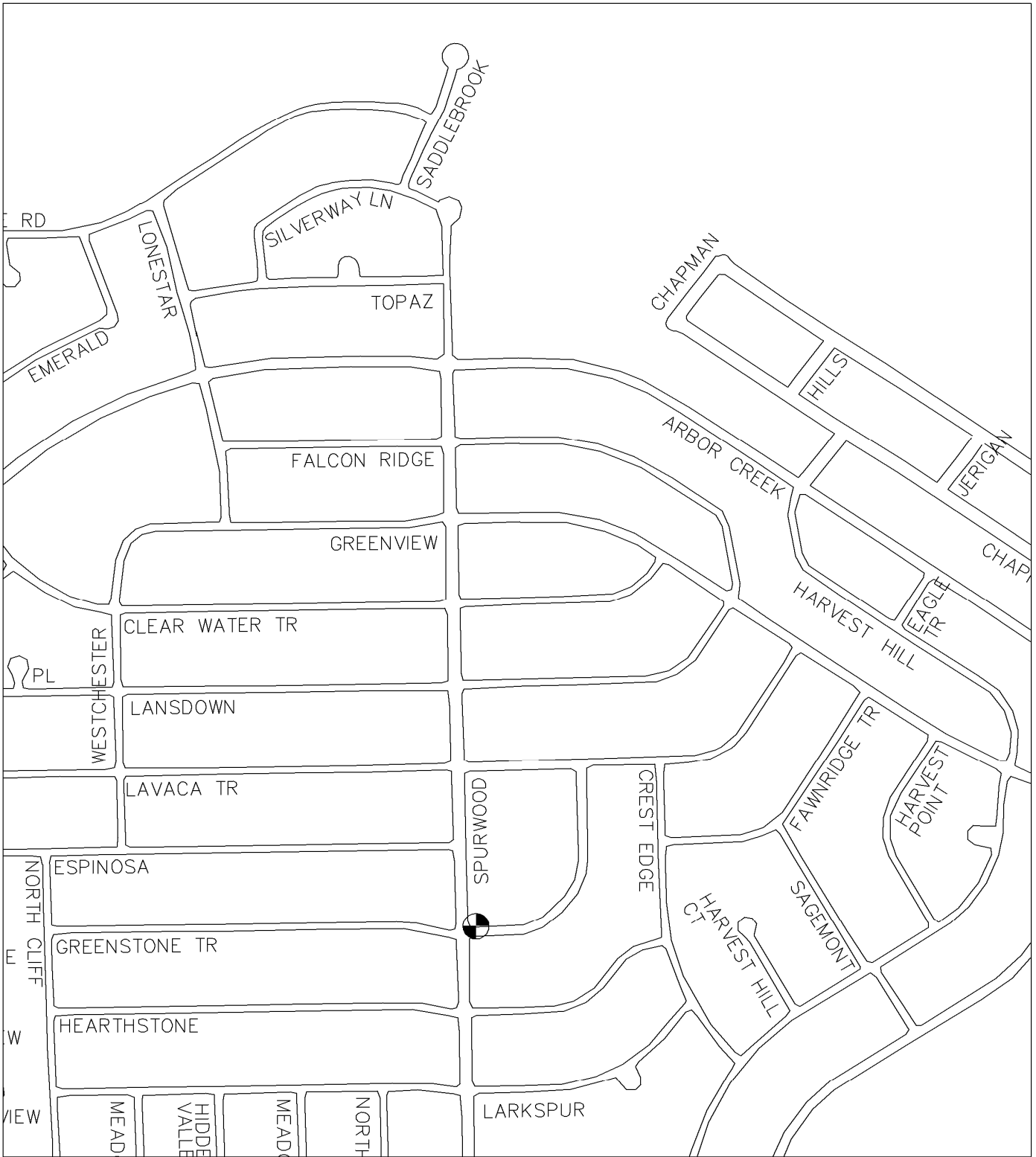

BENCHMARK COC 12
NORTHING 7060295.987
EASTING 2458181.393
ELEVATION 576.269

SCALE: N.T.S.
 DATE:
 SHEET: 1 OF 1

PUBLIC WORKS
 DEPARTMENT

**TEXAS DEPARTMENT OF TRANSPORTATION
GPS SATELLITE STATION
HORIZONTAL - VERTICAL CONTROL DATA
UNITS US SURVEY FEET**

STATION INFORMATION

NAME OF STATION: COC 13
SURVEYED FROM: DALLAS RRP, ARLINGTON RRP
DATE: OCT. 21, 2002
LOCALITY: POLSER ROAD AND ARBOR LANE
COUNTY: DENTON

STATE PLANE COORDINATES N: 7060295.987 E: 2458181.393	ORTHO ELEVATION Z: 503.805	ADJ. FACTOR SURFACE 1.000136506	TEXAS ZONE 4202
--	--	---	-----------------------------------

LATITUDE 33°01'37.21530"N	LONGITUDE 96°54'07.69263"W	ELLIP. HEIGHT E.H. 416.569
-------------------------------------	--------------------------------------	--------------------------------------

DESCRIPTION OF SATELLITE STATION

STATION IS A ROUND 2" BRASS DISK SET IN A CONCRETE CYLINDER BEHIND THE BACK OF CURB.

DISCLAIMER: USING THE VERTICAL DATA IS AT YOUR OWN RISK. SHOULD BE FIELD VERIFIED.

THIS GPS CONTROL POINT IS ON DALLAS MAPSCO PAGE 653-Q. THE STATION IS LOCATED AT THE SOTHWEST CORNER OF THE INTERSECTION OF POLSER RD. AND ARBOR LN.

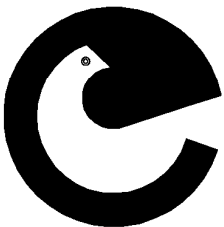
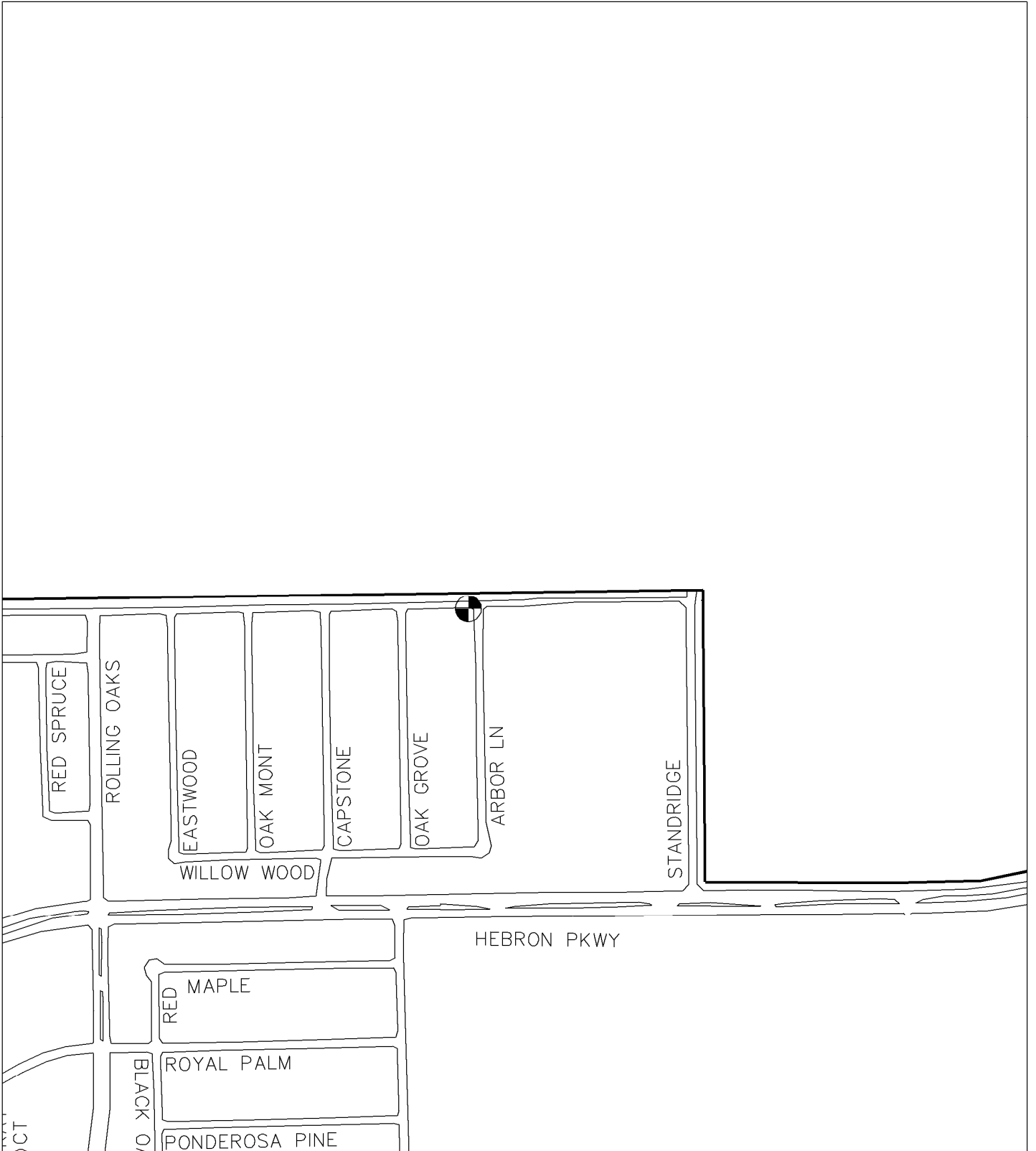

BENCHMARK COC 13
NORTHING 7060756.986
EASTING 2466677.346
ELEVATION 503.805

SCALE: N.T.S.
 DATE:
 SHEET: 1 OF 1

PUBLIC WORKS
 DEPARTMENT

**TEXAS DEPARTMENT OF TRANSPORTATION
GPS SATELLITE STATION
HORIZONTAL - VERTICAL CONTROL DATA
UNITS US SURVEY FEET**

STATION INFORMATION

NAME OF STATION: COC 15
SURVEYED FROM: DALLAS RRP, ARLINGTON RRP
DATE: OCT. 21, 2002
LOCALITY: STEIN WAY AND ALTO
COUNTY: DENTON

STATE PLANE COORDINATES	ORTHO ELEVATION	ADJ. FACTOR SURFACE	TEXAS ZONE
N: 7056935.447 E: 2466998.455	Z: 537.926	1.000136506	4202

LATITUDE	LONGITUDE	ELLIP. HEIGHT
33°01'02.62728"N	96°52'24.74577"W	E.H. 450.984

DESCRIPTION OF SATELLITE STATION

STATION IS A ROUND 2" BRASS DISK SET IN A CONCRETE CYLINDER BEHIND THE BACK OF CURB.

DISCLAIMER: USING THE VERTICAL DATA IS AT YOUR OWN RISK. SHOULD BE FIELD VERIFIED.

THIS GPS CONTROL POINT IS ON DALLAS MAPSCO PAGE 654-X. THE STATION IS LOCATED 3' BEHIND THE CURB AT THE INTERSECTION OF STEIN WAY AND ALTO DRIVE.

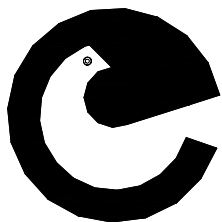
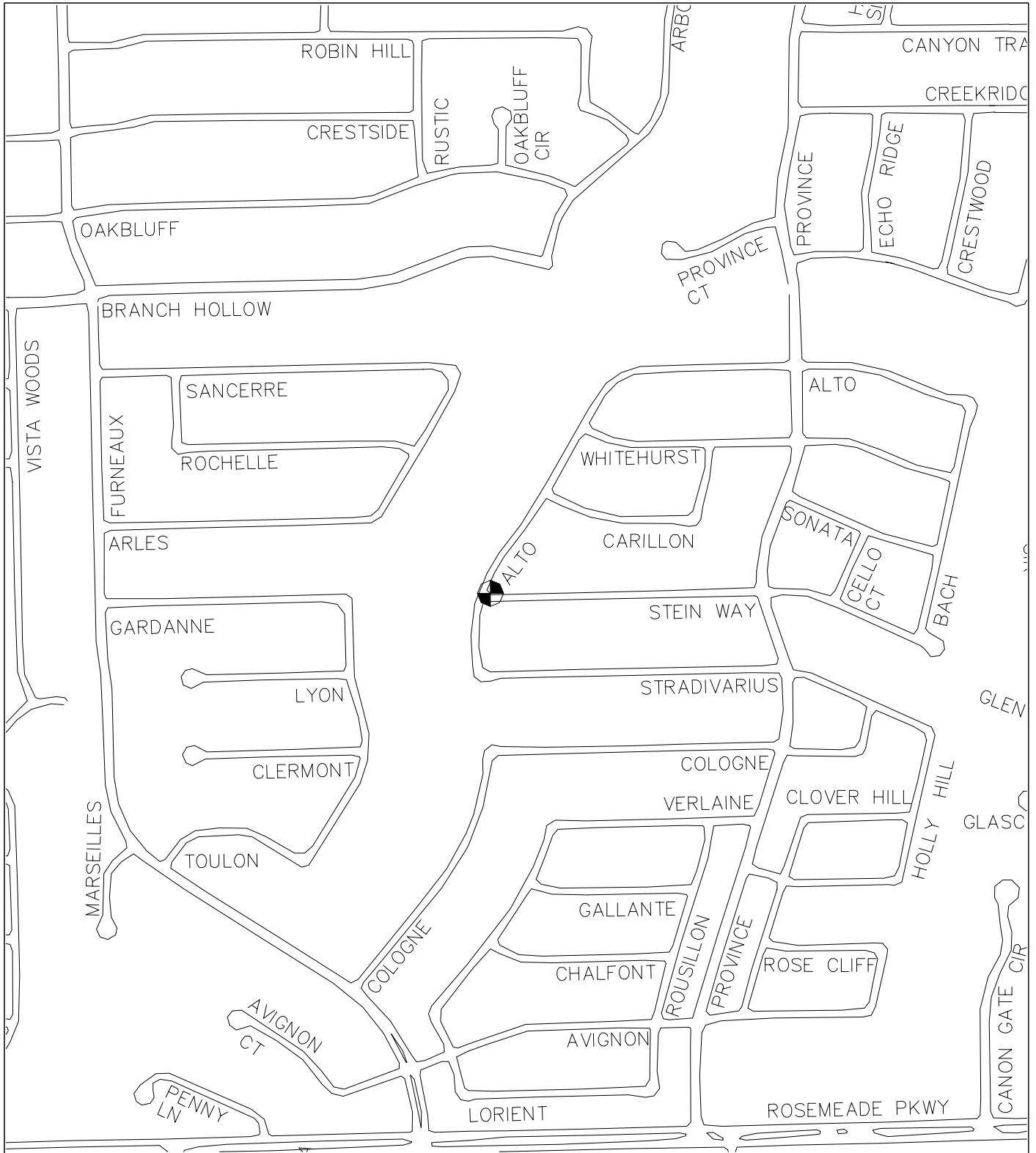

BENCHMARK COC 15
NORTHING 7056935.447
EASTING 2466998.455
ELEVATION 537.926

SCALE: N.T.S.
 DATE:
 SHEET: 1 OF 1

PUBLIC WORKS
 DEPARTMENT

**TEXAS DEPARTMENT OF TRANSPORTATION
GPS SATELLITE STATION
HORIZONTAL - VERTICAL CONTROL DATA
UNITS US SURVEY FEET**

STATION INFORMATION

NAME OF STATION: COC 16
SURVEYED FROM: DALLAS RRP, ARLINGTON RRP
DATE: OCT. 21, 2002
LOCALITY: BRANCH HOLLOW AND VIRGINIA PINE
COUNTY: DENTON

STATE PLANE COORDINATES N: 7056762.224 E: 2458071.613	ORTHO ELEVATION Z: 506.781	ADJ. FACTOR SURFACE 1.000136506	TEXAS ZONE 4202
--	--	---	-----------------------------------

LATITUDE 33°01'02.26870"N	LONGITUDE 96°54'09.61314"W	ELLIP. HEIGHT E.H. 419.496
-------------------------------------	--------------------------------------	--------------------------------------

DESCRIPTION OF SATELLITE STATION

½" I.R.F. IN FIELD W/ CAP STAMPED "GPS SSS"

DISCLAIMER: USING THE VERTICAL DATA IS AT YOUR OWN RISK. SHOULD BE FIELD VERIFIED.

THIS GPS CONTROL POINT IS ON DALLAS MAPSCO PAGE 653-Y. THE STATION IS LOCATED 408' SOUTH OF THE CENTERLINE OF BRANCH HOLLOW DRIVE AND 312' EAST OF THE CENTERLINE OF VIRGINIA PINE.

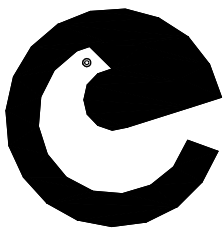
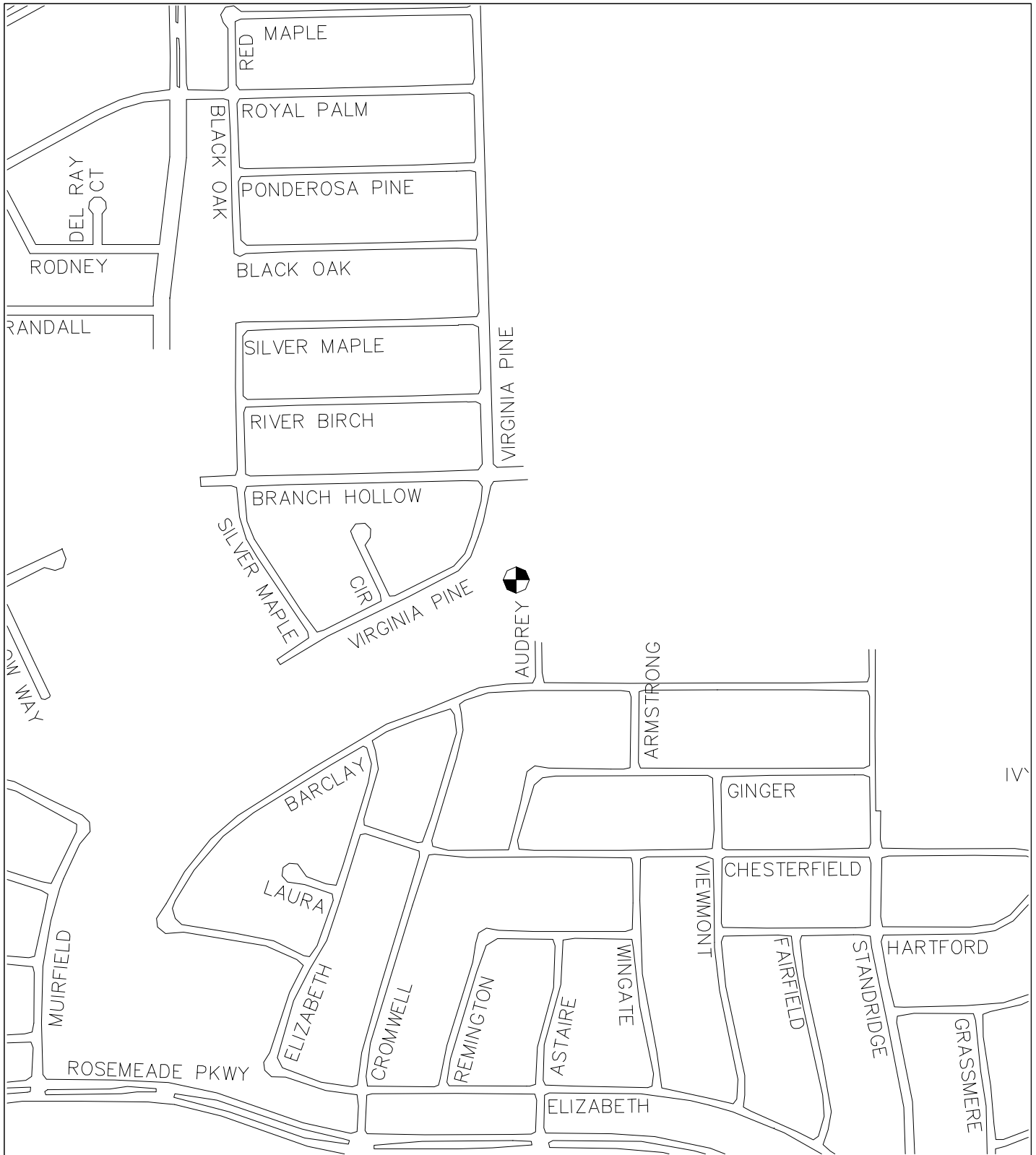

BENCHMARK COC 16
NORTHING 7056762.224
EASTING 2458071.613
ELEVATION 506.781

SCALE: N.T.S.
 DATE:
 SHEET: 1 OF 1

PUBLIC WORKS
 DEPARTMENT

**TEXAS DEPARTMENT OF TRANSPORTATION
GPS SATELLITE STATION
HORIZONTAL - VERTICAL CONTROL DATA
UNITS US SURVEY FEET**

STATION INFORMATION

NAME OF STATION: COC 17
SURVEYED FROM: DALLAS RRP, ARLINGTON RRP
DATE: OCT. 21, 2002
LOCALITY: CREEKSIDE LN. AND CREEK VALLEY BLVD.
COUNTY: DENTON

STATE PLANE COORDINATES	ORTHO ELEVATION	ADJ. FACTOR SURFACE	TEXAS ZONE
N: 7056736.256 E: 2450497.746	Z: 462.824	1.000136506	4202

LATITUDE	LONGITUDE	ELLIP. HEIGHT
33°01'03.14243"N	96°55'38.56508"W	E.H. 375.262

DESCRIPTION OF SATELLITE STATION

STATION IS A ROUND 2" BRASS DISK SET IN A CONCRETE CYLINDER BEHIND THE BACK OF CURB.

DISCLAIMER: USING THE VERTICAL DATA IS AT YOUR OWN RISK. SHOULD BE FIELD VERIFIED.

THIS GPS CONTROL POINT IS ON DALLAS MAPSCO PAGE 653-W. THE STATION IS LOCATED 3' BEHIND THE CURB AT THE INTERSECTION OF CREEKSIDE LANE AND CREEK VALLEY BOULEVARD.

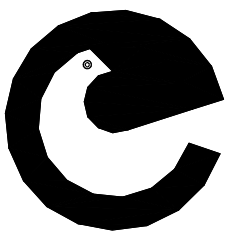
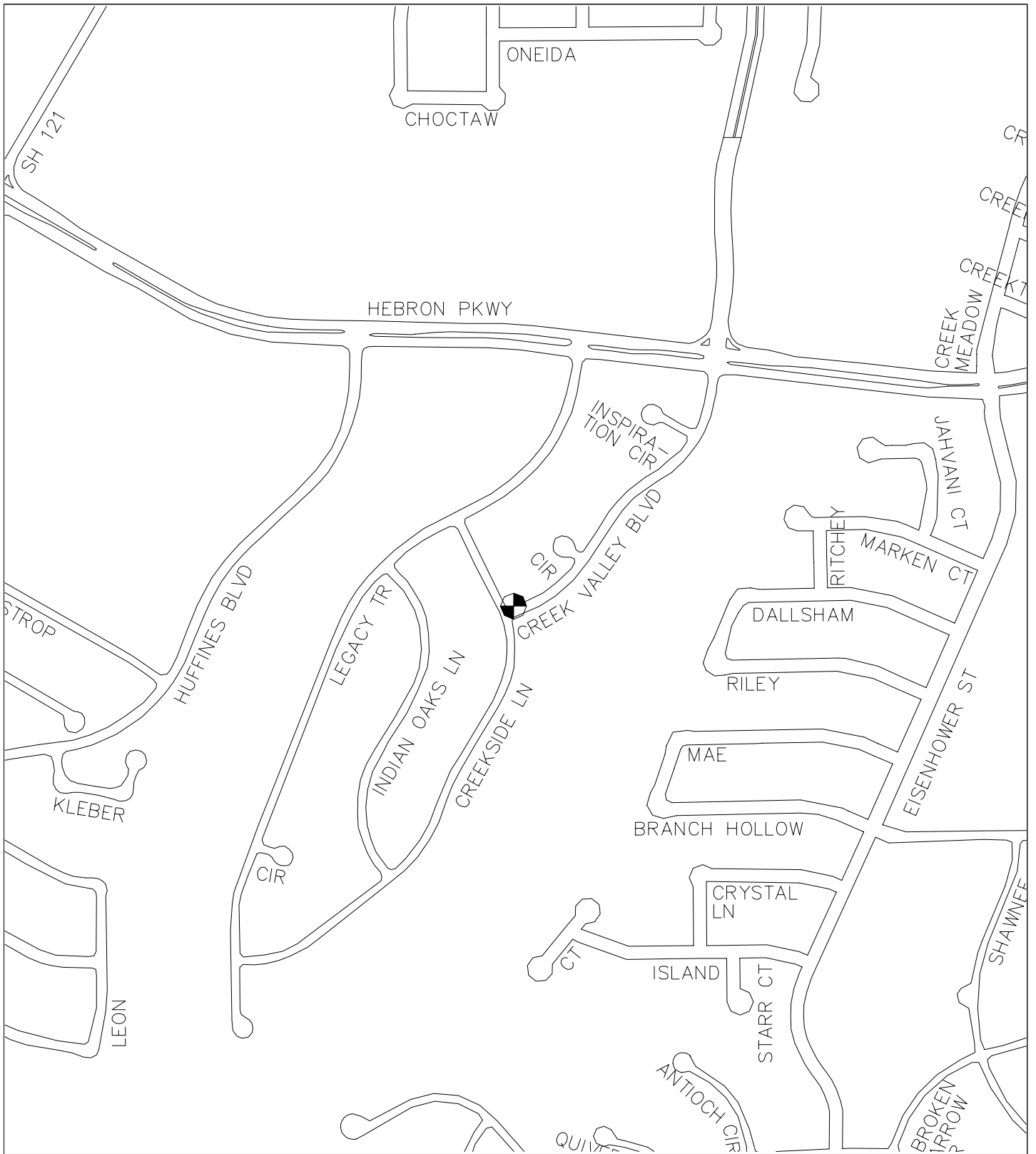

BENCHMARK COC 17
NORTHING 7056736.256
EASTING 2450497.746
ELEVATION 462.824

SCALE: N.T.S.
 DATE:
 SHEET: 1 OF 1

PUBLIC WORKS
 DEPARTMENT

**TEXAS DEPARTMENT OF TRANSPORTATION
GPS SATELLITE STATION
HORIZONTAL - VERTICAL CONTROL DATA
UNITS US SURVEY FEET**

STATION INFORMATION

NAME OF STATION: COC 18
SURVEYED FROM: DALLAS RRP, ARLINGTON RRP
DATE: OCT. 21, 2002
LOCALITY: PETERS COLONY RD. AND FURNEAUX LN.
COUNTY: DENTON

STATE PLANE COORDINATES	ORTHO ELEVATION	ADJ. FACTOR SURFACE	TEXAS ZONE
N: 7052536.097 E: 2466829.998	Z: 544.469	1.000136506	4202

LATITUDE	LONGITUDE	ELLIP. HEIGHT
33°00'19.12594"N	96°52'27.52370"W	E.H. 457.467

DESCRIPTION OF SATELLITE STATION

STATION IS A ROUND 2" BRASS DISK SET IN A CONCRETE CYLINDER BEHIND THE BACK OF CURB.

DISCLAIMER: USING THE VERTICAL DATA IS AT YOUR OWN RISK. SHOULD BE FIELD VERIFIED.

THIS GPS CONTROL POINT IS ON DALLAS MAPSCO PAGE 3-B. THE STATION IS LOCATED 3' BEHIND THE CURB AT THE INTERSECTION OF PETERS COLONY ROAD AND FURNEAUX LANE.

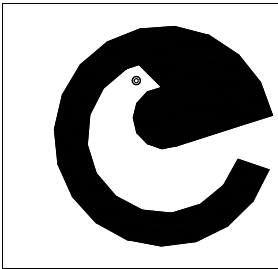
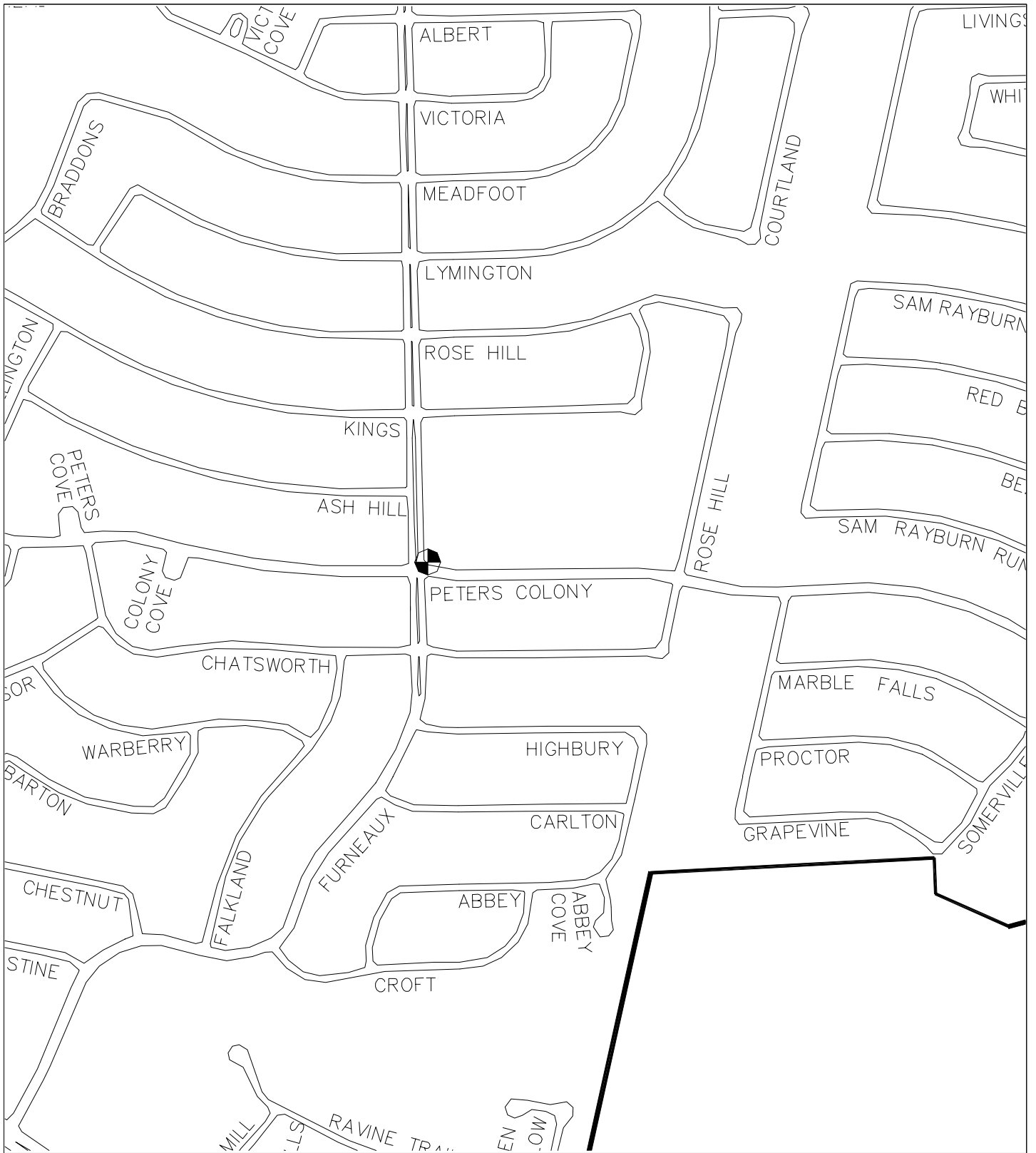

BENCHMARK COC 18
NORTHING 7052536.097
EASTING 2466829.998
ELEVATION 544.469

SCALE: N.T.S.
 DATE:
 SHEET: 1 OF 1

PUBLIC WORKS
 DEPARTMENT

**TEXAS DEPARTMENT OF TRANSPORTATION
GPS SATELLITE STATION
HORIZONTAL - VERTICAL CONTROL DATA
UNITS US SURVEY FEET**

STATION INFORMATION

NAME OF STATION: COC 19
SURVEYED FROM: DALLAS RRP, ARLINGTON RRP
DATE: OCT. 21, 2002
LOCALITY: LUALLEN DR. AND BRIGHTON DR.
COUNTY: DENTON

STATE PLANE COORDINATES	ORTHO ELEVATION	ADJ. FACTOR SURFACE	TEXAS ZONE
N: 7053134.458 E: 2458559.924	Z: 506.872	1.000136506	4202

LATITUDE	LONGITUDE	ELLIP. HEIGHT
33°00'26.30196"N	96°54'04.52686"W	E.H. 419.562

DESCRIPTION OF SATELLITE STATION

STATION IS A ROUND 2" BRASS DISK SET IN A CONCRETE CYLINDER BEHIND THE BACK OF CURB.

DISCLAIMER: USING THE VERTICAL DATA IS AT YOUR OWN RISK. SHOULD BE FIELD VERIFIED.

THIS GPS CONTROL POINT IS ON DALLAS MAPSCO PAGE 2-C. THE STATION IS LOCATED 3' BEHIND THE EAST CURB LINE OF LUALLEN DRIVE. THE STATION IS LOCATED 137' SOUTH OF THE CENTERLINE OF BRIGHTON DRIVE. STATION IS LOCATED 478' NORTH OF THE CENTERLINE OF WALKER DRIVE.

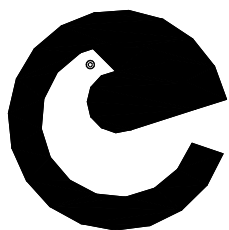
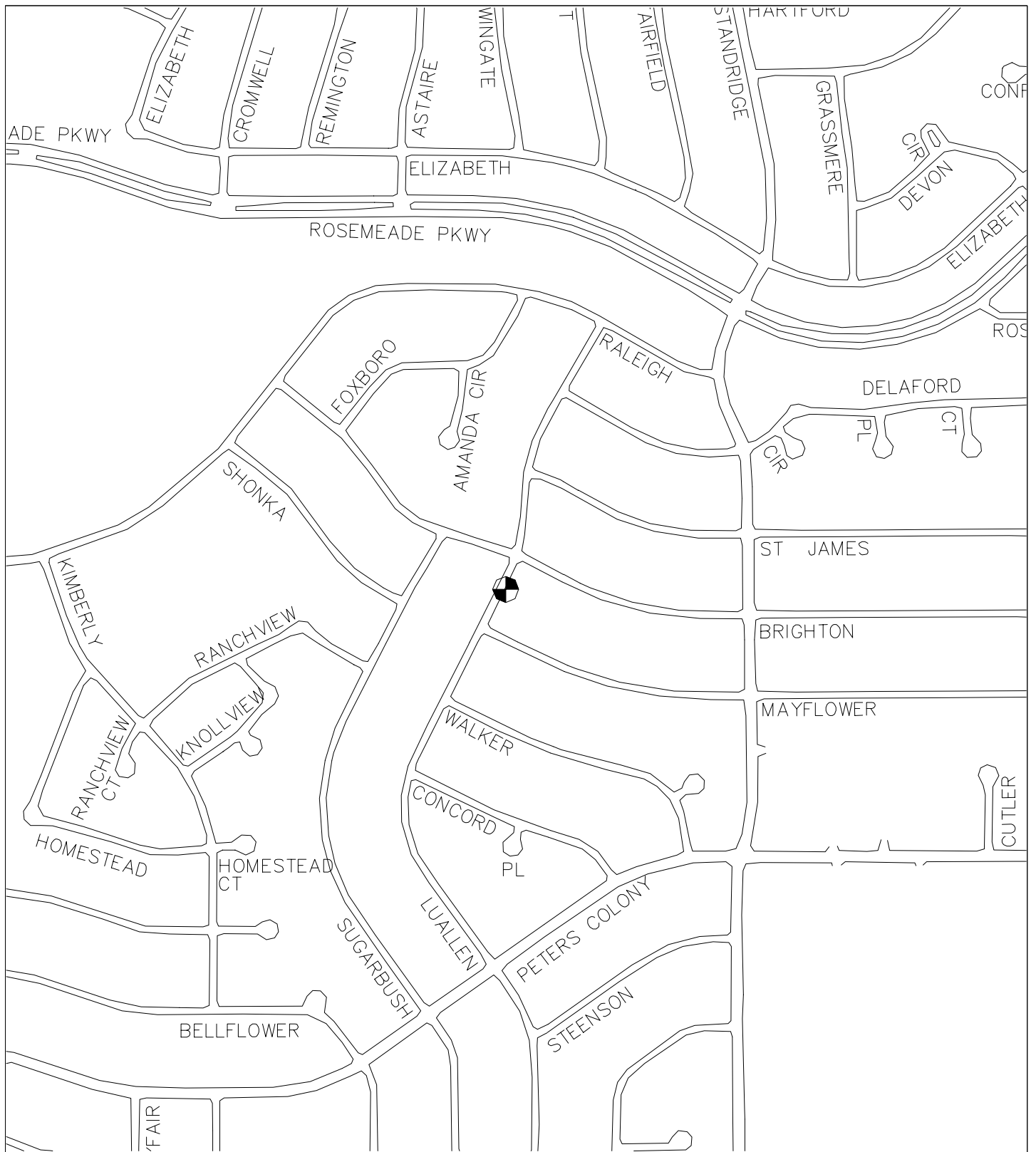

**BENCHMARK COC 19
 NORTHING 7053134.458
 EASTING 2458559.924
 ELEVATION 506.872**

SCALE: N.T.S.
 DATE:
 SHEET: 1 OF 1

PUBLIC WORKS
 DEPARTMENT

**TEXAS DEPARTMENT OF TRANSPORTATION
GPS SATELLITE STATION
HORIZONTAL - VERTICAL CONTROL DATA
UNITS US SURVEY FEET**

STATION INFORMATION

NAME OF STATION: COC 20
SURVEYED FROM: DALLAS RRP, ARLINGTON RRP
DATE: OCT. 21, 2002
LOCALITY: CIMARRON DR.
COUNTY: DENTON

STATE PLANE COORDINATES	ORTHO ELEVATION	ADJ. FACTOR SURFACE	TEXAS ZONE
N: 7052648.820 E: 2450563.374	Z: 465.977	1.000136506	4202

LATITUDE	LONGITUDE	ELLIP. HEIGHT
33°00'22.69132 "N	96°55'38.51300"W	E.H. 378.367

DESCRIPTION OF SATELLITE STATION

STATION IS A ROUND 2" BRASS DISK SET IN A CONCRETE CYLINDER BEHIND THE BACK OF CURB.

DISCLAIMER: USING THE VERTICAL DATA IS AT YOUR OWN RISK. SHOULD BE FIELD VERIFIED.

THIS GPS CONTROL POINT IS ON DALLAS MAPSCO PAGE 2-A. THE STATION IS LOCATED 3' BEHIND THE CURB LINE OF THE NORTHEAST CORNER OF THE CIMARRON DRIVE CUL DE SAC.

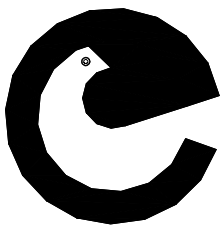
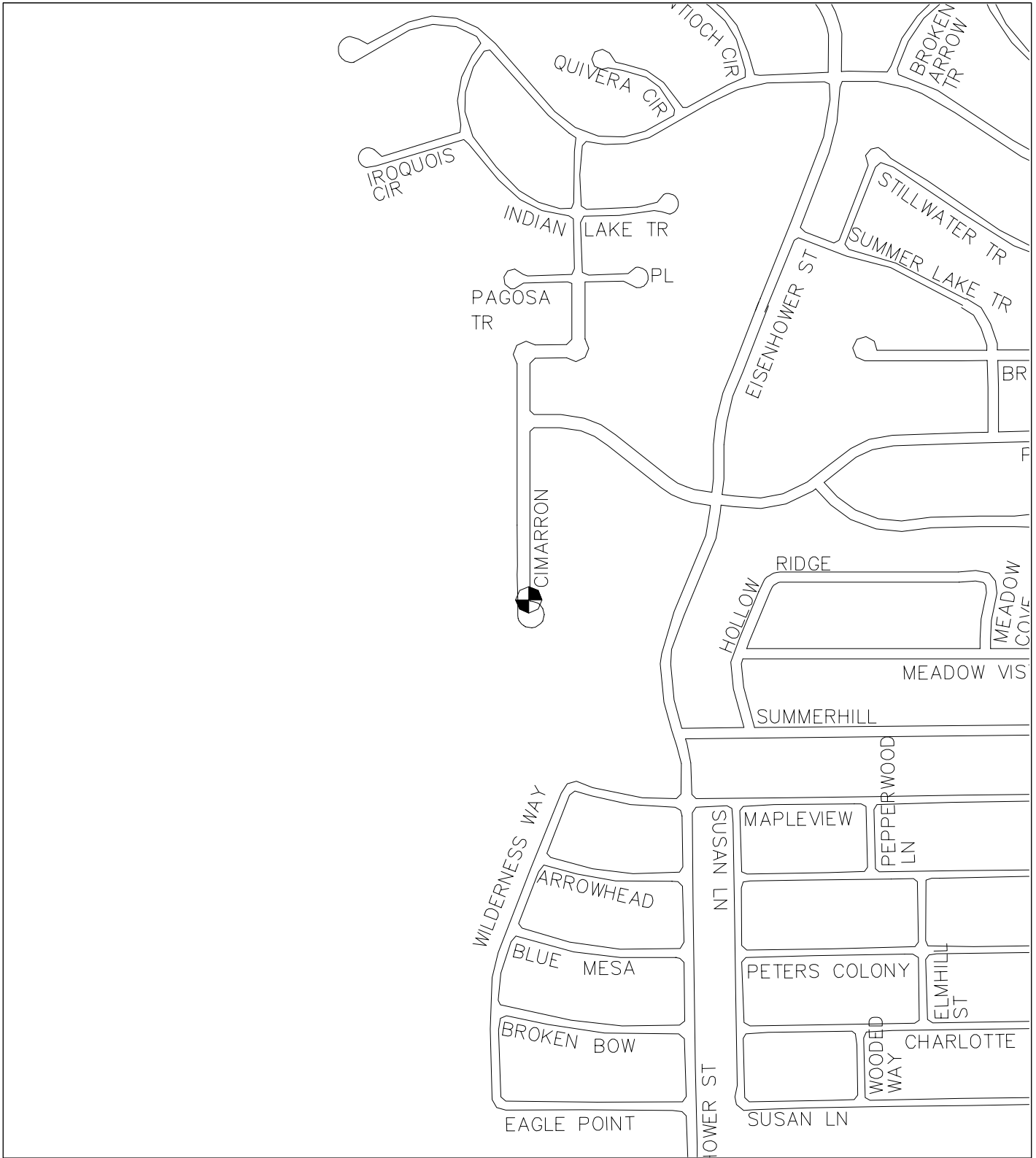

BENCHMARK COC 20
NORTHING 7052648.820
EASTING 2450563.374
ELEVATION 465.977

SCALE: N.T.S.
 DATE:
 SHEET: 1 OF 1

PUBLIC WORKS
 DEPARTMENT

**TEXAS DEPARTMENT OF TRANSPORTATION
GPS SATELLITE STATION
HORIZONTAL - VERTICAL CONTROL DATA
UNITS US SURVEY FEET**

STATION INFORMATION

NAME OF STATION: COC 21
SURVEYED FROM: DALLAS RRP, ARLINGTON RRP
DATE: OCT. 21, 2002
LOCALITY: FRANKFORD RD. @ B & N R.R. CROSSING
COUNTY: DENTON

STATE PLANE COORDINATES N: 7049544.714 E: 2467305.290	ORTHO ELEVATION Z: 545.693	ADJ. FACTOR SURFACE 1.000136506	TEXAS ZONE 4202
--	--	---	-----------------------------------

LATITUDE 32°59'49.45635"N	LONGITUDE 96°52'22.48675"W	ELLIP. HEIGHT E.H. 458.676
-------------------------------------	--------------------------------------	--------------------------------------

DESCRIPTION OF SATELLITE STATION

STATION IS A ROUND 2" BRASS DISK SET IN A CONCRETE CYLINDER BEHIND THE BACK OF CURB.

DISCLAIMER: USING THE VERTICAL DATA IS AT YOUR OWN RISK. SHOULD BE FIELD VERIFIED.

THIS GPS CONTROL POINT IS ON DALLAS MAPSCO PAGE 3-F. THE STATION IS LOCATED IN THE MEDIAN ON FRANKFORD ROAD AT THE CROSSING OF THE B & N RAILROAD.

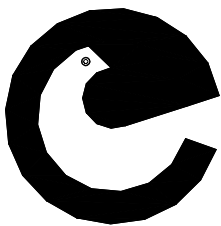
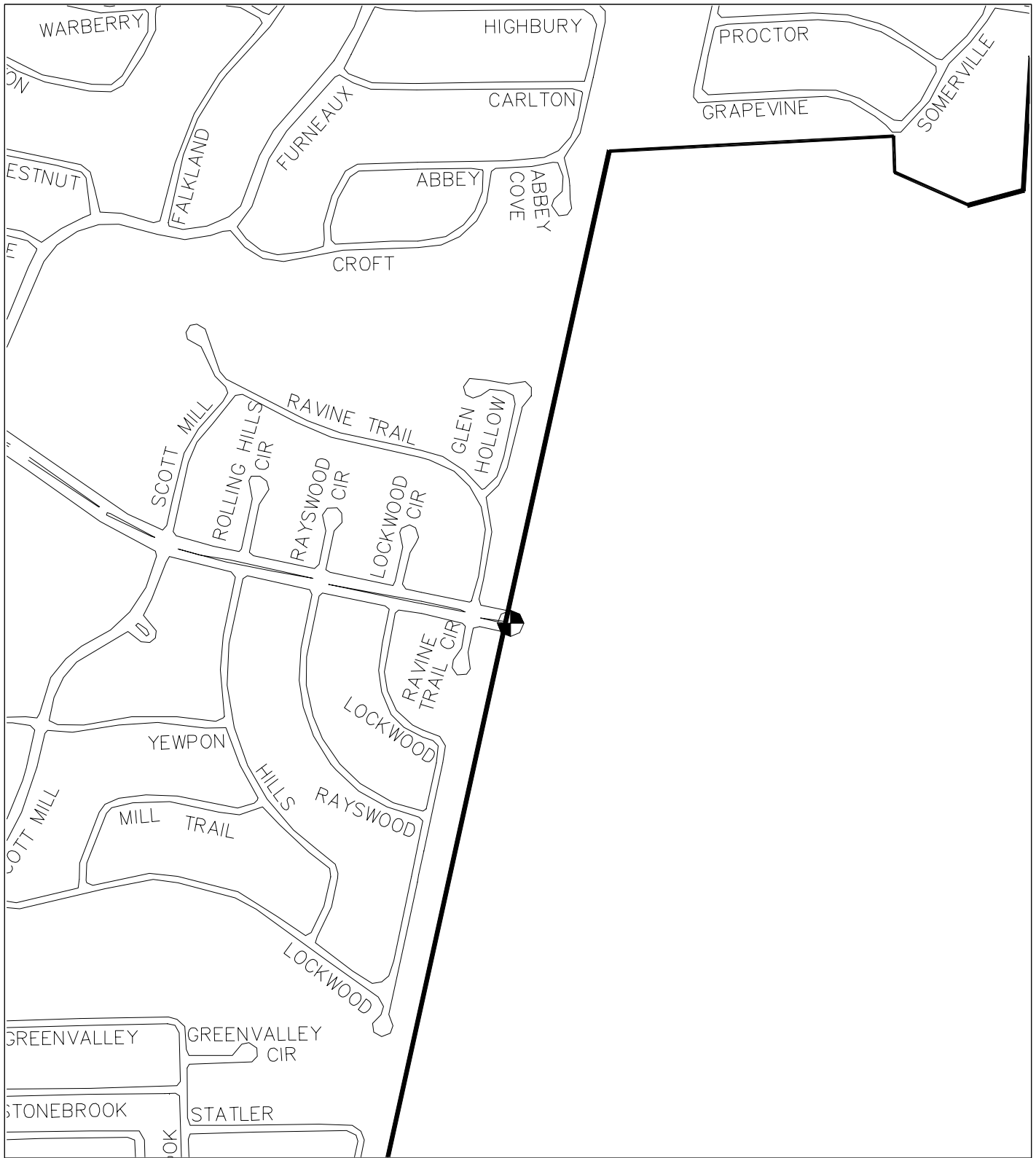

BENCHMARK COC 21
NORTHING 7049544.714
EASTING 2467305.290
ELEVATION 545.693

SCALE: N.T.S.
 DATE:
 SHEET: 1 OF 1

PUBLIC WORKS
 DEPARTMENT

**TEXAS DEPARTMENT OF TRANSPORTATION
GPS SATELLITE STATION
HORIZONTAL - VERTICAL CONTROL DATA
UNITS US SURVEY FEET**

STATION INFORMATION

NAME OF STATION: COC 22
SURVEYED FROM: DALLAS RRP, ARLINGTON RRP
DATE: OCT. 21, 2002
LOCALITY: CROOKED CREEK DR. AND WOODBURY
COUNTY: DENTON

STATE PLANE COORDINATES	ORTHO ELEVATION	ADJ. FACTOR SURFACE	TEXAS ZONE
N: 7048858.623 E: 2460969.701	Z: 486.663	1.000136506	4202

LATITUDE	LONGITUDE	ELLIP. HEIGHT
32°59'43.63291"N	96°53'36.99764"W	E.H. 399.396

DESCRIPTION OF SATELLITE STATION

STATION IS A ROUND 2" BRASS DISK SET IN A CONCRETE CYLINDER BEHIND THE BACK OF CURB.

DISCLAIMER: USING THE VERTICAL DATA IS AT YOUR OWN RISK. SHOULD BE FIELD VERIFIED.

THIS GPS CONTROL POINT IS ON DALLAS MAPSCO PAGE 2-H. THE STATION IS LOCATED AT THE NORTHWEST CORNER OF CROOKED CREEK DRIVE AND WOODBURY, ADJACENT TO THE GREENBELT PARK.

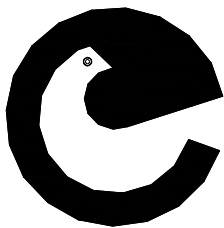
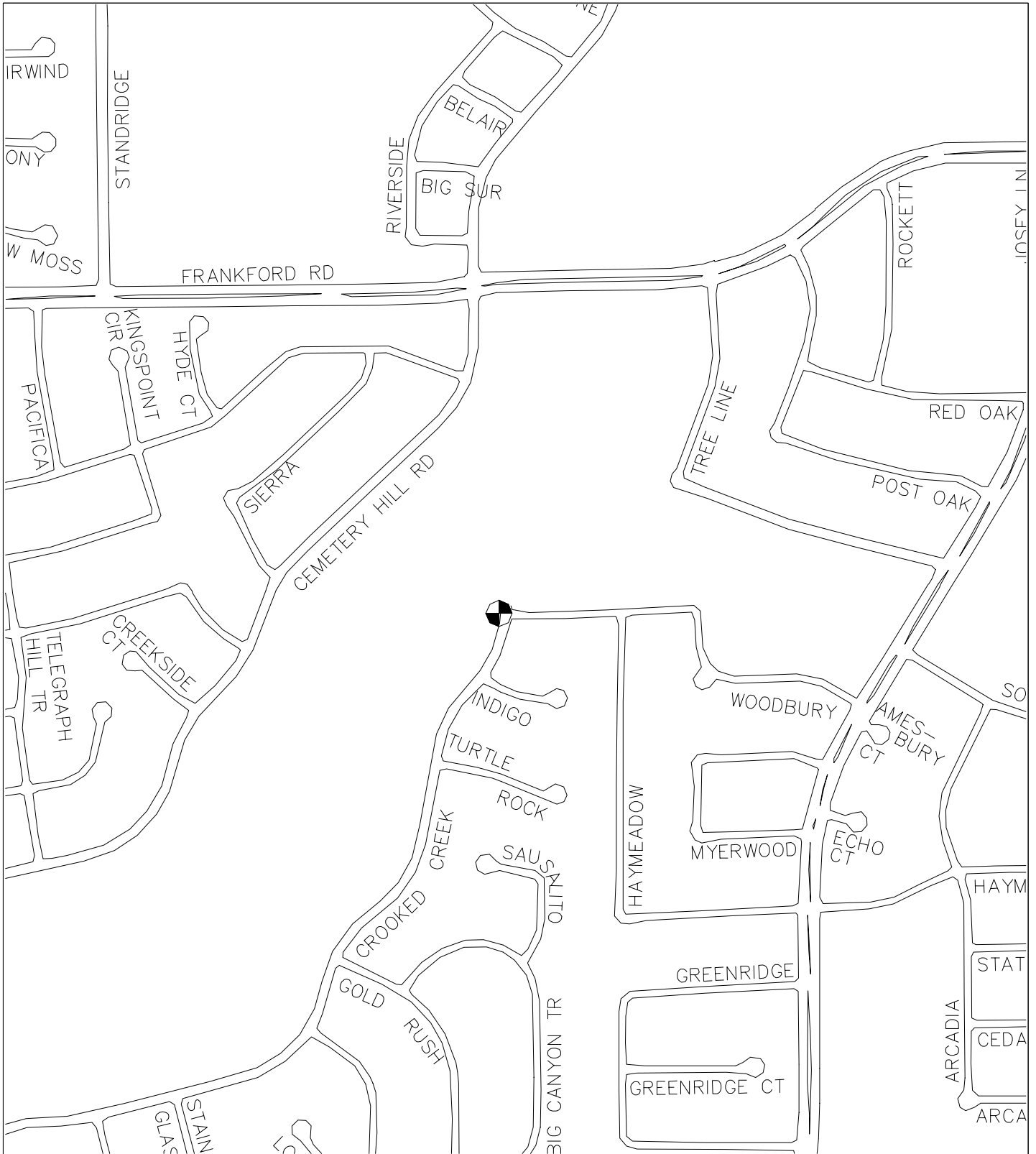

BENCHMARK COC 22
NORTHING 7048858.623
EASTING 2460969.701
ELEVATION 486.663

SCALE: N.T.S.
 DATE:
 SHEET: 1 OF 1

PUBLIC WORKS
 DEPARTMENT

**TEXAS DEPARTMENT OF TRANSPORTATION
GPS SATELLITE STATION
HORIZONTAL - VERTICAL CONTROL DATA
UNITS US SURVEY FEET**

STATION INFORMATION

NAME OF STATION: COC 23
SURVEYED FROM: DALLAS RRP, ARLINGTON RRP
DATE: OCT. 21, 2002
LOCALITY: STAFFORDSHIRE DR. AND MAGNOLIA DR.
COUNTY: DENTON

STATE PLANE COORDINATES	ORTHO ELEVATION	ADJ. FACTOR SURFACE	TEXAS ZONE
N: 7048909.043 E: 2455302.539	Z: 511.325	1.000136506	4202

LATITUDE	LONGITUDE	ELLIP. HEIGHT
32°59'44.98430"N	96°54'43.52717"W	E.H. 423.847

DESCRIPTION OF SATELLITE STATION

STATION IS A ROUND 2" BRASS DISK SET IN A CONCRETE CYLINDER BEHIND THE BACK OF CURB.

DISCLAIMER: USING THE VERTICAL DATA IS AT YOUR OWN RISK. SHOULD BE FIELD VERIFIED.

THIS GPS CONTROL POINT IS ON DALLAS MAPSCO PAGE 2-F. THE STATION IS LOCATED 3' BEHIND THE CURB AT THE SOUTHWEST CORNER OF STAFFORDSHIRE DRIVE AND MAGNOLIA DRIVE.

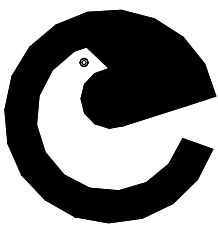
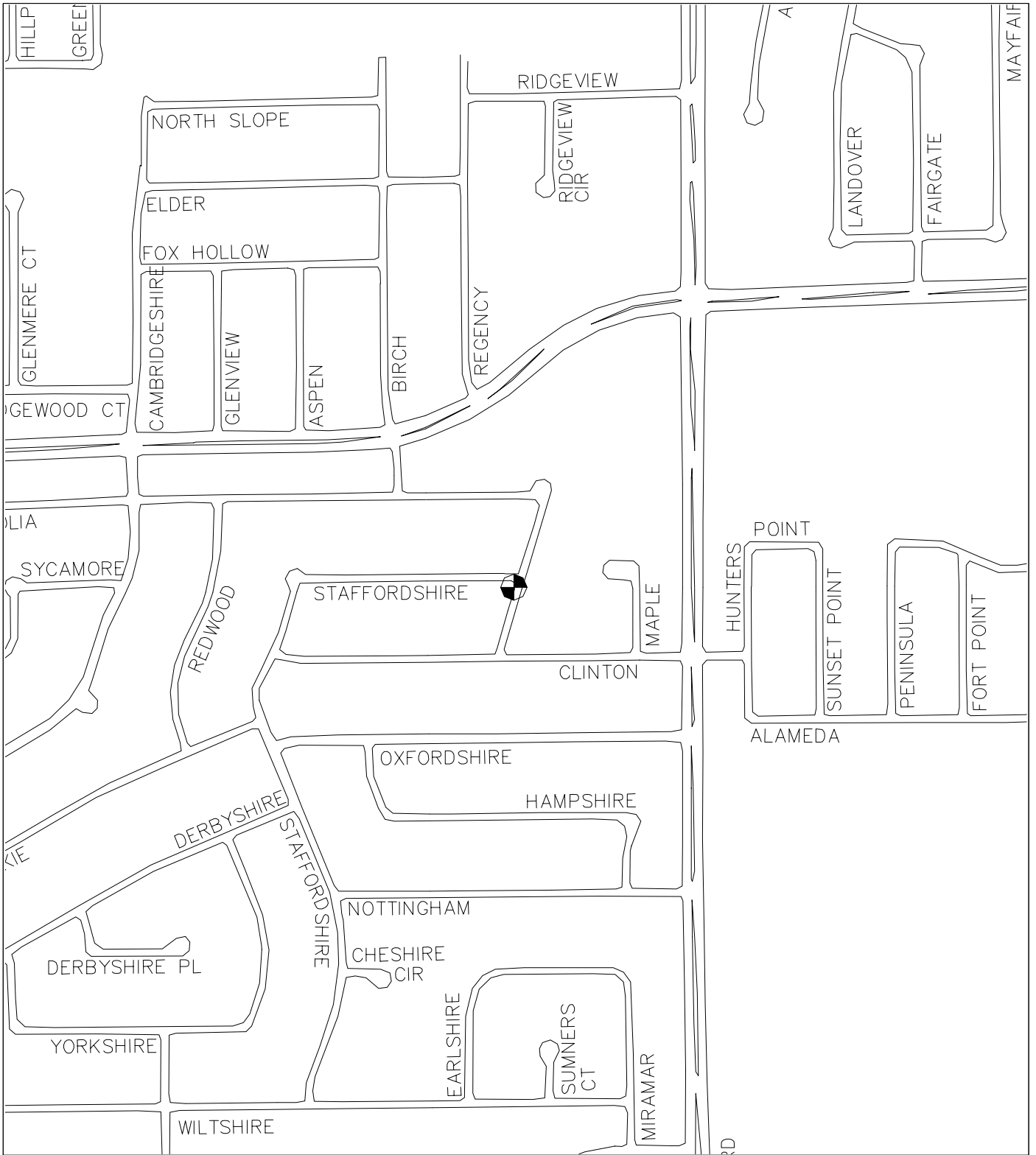

BENCHMARK COC 23
NORTHING 7048909.043
EASTING 2455302.539
ELEVATION 511.325

SCALE: N.T.S.
 DATE:
 SHEET: 1 OF 1

PUBLIC WORKS
 DEPARTMENT

**TEXAS DEPARTMENT OF TRANSPORTATION
GPS SATELLITE STATION
HORIZONTAL - VERTICAL CONTROL DATA
UNITS US SURVEY FEET**

STATION INFORMATION

NAME OF STATION: COC 24
SURVEYED FROM: DALLAS RRP, ARLINGTON RRP
DATE: OCT. 21, 2002
LOCALITY: FRANKFORD RD. AND COMMODORE DR.
COUNTY: DENTON

STATE PLANE COORDINATES	ORTHO ELEVATION	ADJ. FACTOR SURFACE	TEXAS ZONE
N: 7048762.623 E: 2449714.625	Z: 455.826	1.000136506	4202

LATITUDE	LONGITUDE	ELLIP. HEIGHT
32°59'44.36655"N	96°55'49.16135"W	E.H. 368.142

DESCRIPTION OF SATELLITE STATION

STATION IS A ROUND 2" BRASS DISK SET IN A CONCRETE CYLINDER BEHIND THE BACK OF CURB.

DISCLAIMER: USING THE VERTICAL DATA IS AT YOUR OWN RISK. SHOULD BE FIELD VERIFIED.

THIS GPS CONTROL POINT IS ON DALLAS MAPSCO PAGE 1B-H. THE STATION IS LOCATED 3' BEHIND THE NORTH CURB LINE AT THE INTERSECTION OF FRANKFORD ROAD AND COMMODORE ROAD.

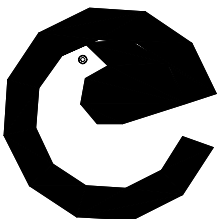
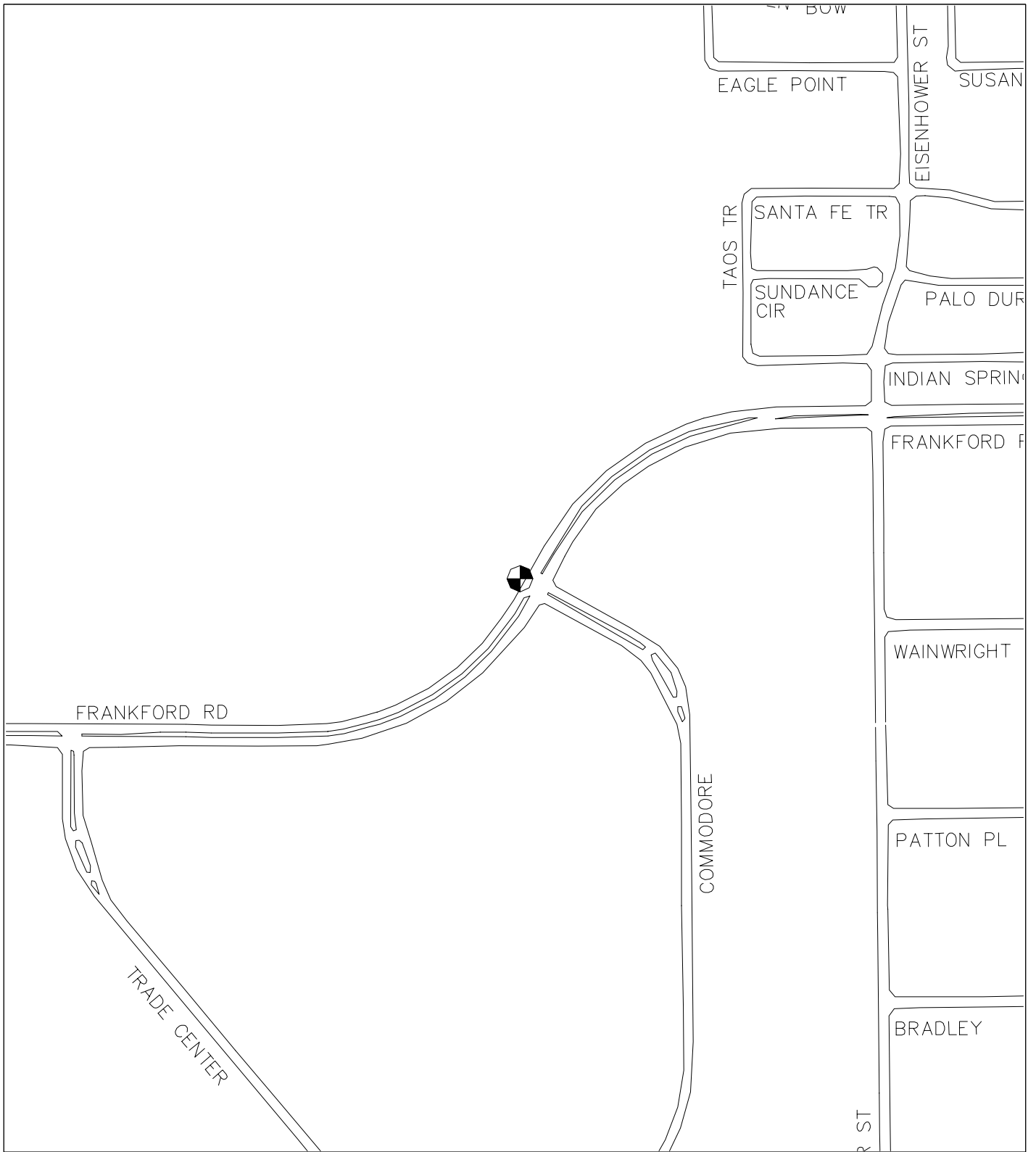

BENCHMARK COC 24
NORTHING 7048762.623
EASTING 2449714.625
ELEVATION 455.826

SCALE: N.T.S.
 DATE:
 SHEET: 1 OF 1

PUBLIC WORKS
 DEPARTMENT

**TEXAS DEPARTMENT OF TRANSPORTATION
GPS SATELLITE STATION
HORIZONTAL - VERTICAL CONTROL DATA
UNITS US SURVEY FEET**

STATION INFORMATION

NAME OF STATION: COC 26
SURVEYED FROM: DALLAS RRP, ARLINGTON RRP
DATE: OCT. 21, 2002
LOCALITY: CENTRAL SERVICE CENTER
COUNTY: DENTON

STATE PLANE COORDINATES	ORTHO ELEVATION	ADJ. FACTOR SURFACE	TEXAS ZONE
N: 7045065.594 E: 2449676.118	Z: 451.476	1.000136506	4202

LATITUDE	LONGITUDE	ELLIP. HEIGHT
32°59'07.79344"N	96°55'50.26197"W	E.H. 363.753

DESCRIPTION OF SATELLITE STATION

STATION IS A ROUND 2" BRASS DISK SET IN A CONCRETE CYLINDER BEHIND THE BACK OF CURB.

DISCLAIMER: USING THE VERTICAL DATA IS AT YOUR OWN RISK. SHOULD BE FIELD VERIFIED.

THIS GPS CONTROL POINT IS ON DALLAS MAPSCO PAGE 1B-M. THE STATION IS LOCATED IN THE SOUTH CORNER OF THE CITY OF CARROLLTON'S CENTRAL SERVICE CENTER.

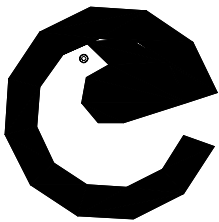
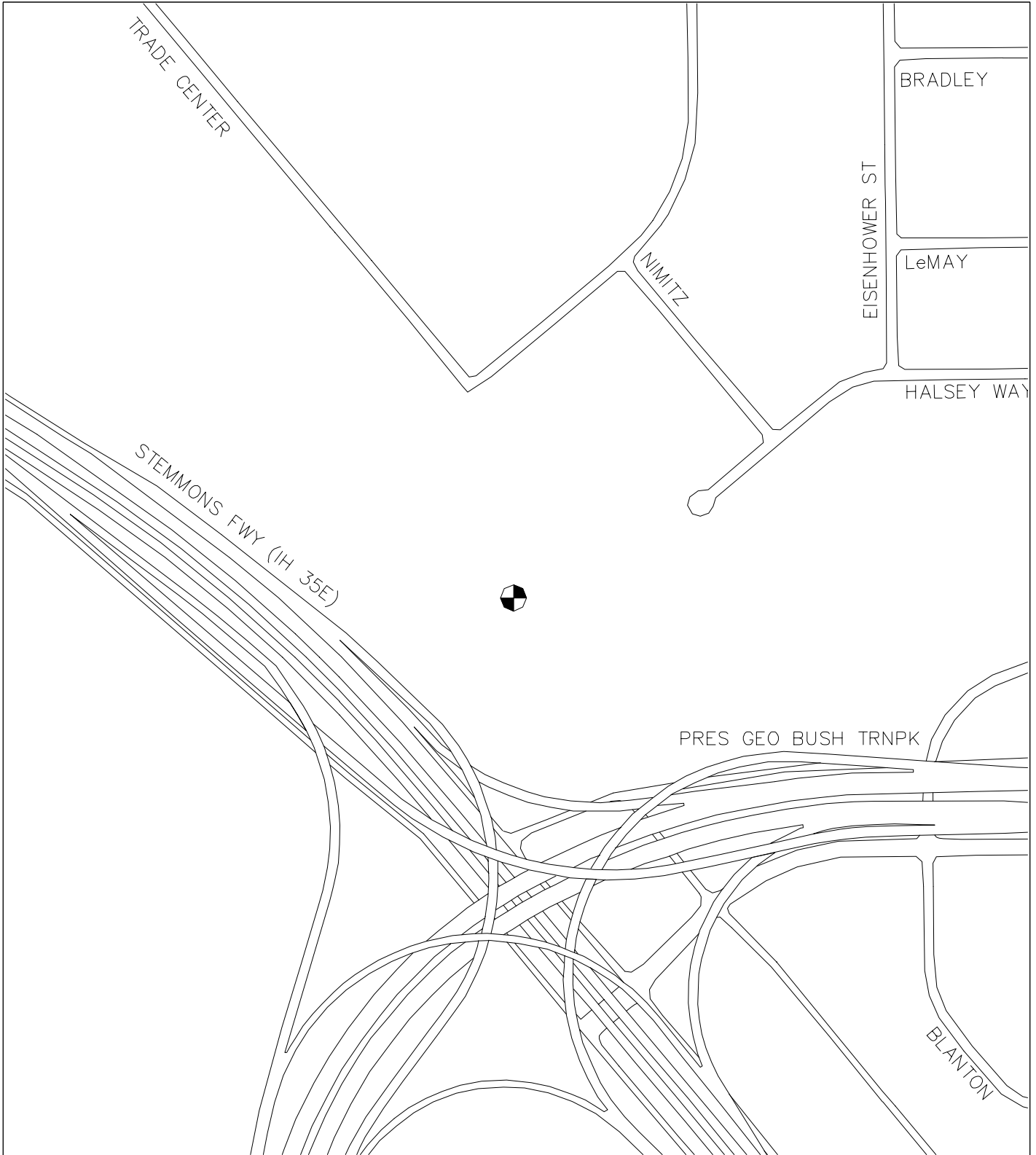

BENCHMARK COC 26
NORTHING 7045065.594
EASTING 2449676.118
ELEVATION 451.476

SCALE: N.T.S.
DATE:
SHEET: 1 OF 1

PUBLIC WORKS
DEPARTMENT

**TEXAS DEPARTMENT OF TRANSPORTATION
GPS SATELLITE STATION
HORIZONTAL - VERTICAL CONTROL DATA
UNITS US SURVEY FEET**

STATION INFORMATION

NAME OF STATION: D0430051
SURVEYED FROM: DALLAS RRP, ARLINGTON RRP
DATE: JUN. 13, 2000
LOCALITY: LLOYD DRIVE AND SH 289 (PRESTON RD.)
COUNTY: DALLAS
HIGHWAY: SH 289

STATE PLANE COORDINATES	ORTHO ELEVATION	ADJ. FACTOR SURFACE	TEXAS ZONE
N: 7053482.25771 E: 2490979.37440	Z: 666.931	1.000152710	4202

LATITUDE	LONGITUDE	ELLIP. HEIGHT
33°00'24.69982"N	96°47'43.77746"W	E.H. 580.869

DESCRIPTION OF SATELLITE STATION

STATION IS A ROUND 3 ½" ALUMINUM ALLOY TxDOT DISC SET ATOP A 5/8" PIECE OF STEEL REBAR, FLUSH WITH THE GROUND, AND IS STAMPED D0430051.

DISCLAIMER: USING THE VERTICAL DATA IS AT YOUR OWN RISK. SHOULD BE FIELD VERIFIED.

THE GPS CONTROL POINT IS ON DALLAS COUNTY MAPSCO PAGE 5-C. THE STATION IS SOUTH OF THE INTERSECTION OF LLOYD DRIVE AND SH 289.

**TEXAS DEPARTMENT OF TRANSPORTATION
GPS SATELLITE STATION
HORIZONTAL - VERTICAL CONTROL DATA
UNITS US SURVEY FEET**

STATION INFORMATION

NAME OF STATION: RE570085
SURVEYED FROM: ARLINGTON, DISTRICT 1
DATE: JUN. 6, 2000
LOCALITY: NORTHWEST DALLAS IH 635 @ IH 35E
COUNTY: DALLAS
HIGHWAY: IH 635

STATE PLANE COORDINATES	ORTHO ELEVATION	ADJ. FACTOR SURFACE	TEXAS ZONE
N: 7017321.92333 E: 2459486.22984	Z: 447.286	1.000136506	4202

LATITUDE	LONGITUDE	ELLIP. HEIGHT
32°54'31.83376"N	96°54'00.05480"W	E.H. 359.719

DESCRIPTION OF SATELLITE STATION

STATION IS A ROUND 3 ½" ALUMINUM ALLOY TxDOT DISC SET ATOP A 5/8" PIECE OF STEEL REBAR, FLUSH WITH THE GROUND, AND IS STAMPED S0570085. **REVISED TO RE570085.**

DISCLAIMER: USING THE VERTICAL DATA IS AT YOUR OWN RISK. SHOULD BE FIELD VERIFIED.

TO REACH THE STATION FROM THE INTERSECTION OF IH 35 AND VALWOOD PARKWAY IN NORTHWEST DALLAS, GO SOUTH ON IH 35 E FOR 1.6 MILES TO THE HARRY HINES EXIT AND FOLLOW IT SOUTH FOR 0.6 MILES TO THE INTERSECTION OF IH 635 NORTH FRONTAGE ROAD. STATION IS IN THE SOUTHWEST QUADRANT OF INTERSECTION AND WEST OF THE SOUTH BOUND ROAD UNDER IH 635 (EMERALD ST.)

STATION 33' (SOUTH) FROM THE CENTERLINE OF IH 635 NORTH FRONTAGE ROAD, 89' (WEST) FROM THE CENTERLINE OF EMERALD ST. 96' (NORTH, NORTHWEST) FROM A CONCRETE COLUMN SUPPORTING IH 635 WEST BOUND ON RAMP, AND 3' (SOUTH) FROM A DELINEATOR POST.

**TEXAS DEPARTMENT OF TRANSPORTATION
GPS SATELLITE STATION
HORIZONTAL - VERTICAL CONTROL DATA
UNITS US SURVEY FEET**

STATION INFORMATION

NAME OF STATION: R0610118
SURVEYED FROM: ARLINGTON
DATE: DEC. 10, 1998
LOCALITY: BETWEEN SH 121 & US 380
COUNTY: DENTON
HIGHWAY: FM 423

STATE PLANE COORDINATES	ORTHO ELEVATION	ADJ. FACTOR SURFACE	TEXAS ZONE
N: 7074606.84157 E: 2461781.21816	Z: 584.002	1.000150630	4202

LATITUDE	LONGITUDE	ELLIP. HEIGHT
33°03'58.26265"N	96°53'22.83525"W	E.H. 497.201

DESCRIPTION OF SATELLITE STATION

STATION IS A ROUND 3 ½" ALUMINUM ALLOY TxDOT DISC SET ATOP A 5/8" PIECE OF STEEL REBAR, FLUSH WITH THE GROUND, AND IS STAMPED R0610118.

DISCLAIMER: USING THE VERTICAL DATA IS AT YOUR OWN RISK. SHOULD BE FIELD VERIFIED.

THE GPS CONTROL POINT IS ON DALLAS MAPSCO 554-W. THE STATION IS IN THE NORTH R.O.W. LINE OF MAIN STREET AND SH 121.

STATION IS LOCATED IN THE NORTHWEST QUADRANT OF THE INTERSECTION OF SH 121 AND FM 423, 12' NORTHEAST OF A POWER POLE, 9' SOUTHEAST FROM THE SOUTH EDGE OF A CONCRETE SIDEWALK, AND 51' SOUTH OF A SIGN IN FRONT OF THE SHELL GAS STATION.

**TEXAS DEPARTMENT OF TRANSPORTATION
GPS SATELLITE STATION
HORIZONTAL - VERTICAL CONTROL DATA
UNITS US SURVEY FEET**

STATION INFORMATION

NAME OF STATION: R0610096
SURVEYED FROM: DALLAS REF-1, ARLINGTON
DATE: JUN. 20, 1996
LOCALITY: CITY OF CARROLLTON
COUNTY: DENTON
HIGHWAY: IH 35 E

STATE PLANE COORDINATES	ORTHO ELEVATION	ADJ. FACTOR SURFACE	TEXAS ZONE
N: 7047746.87233 E: 2445861.91929	Z: 464.924	1.000150630	4202

LATITUDE	LONGITUDE	ELLIP. HEIGHT
32°59'34.88392"N	96°56'34.57328"W	E.H. 377.133

DESCRIPTION OF SATELLITE STATION

STATION IS A P.K. NAIL AND 5/8" WASHER, SET FLUSH WITH THE GROUND, POINT IS NOT STAMPED. NOTE HEAD OF PK NAIL MISSING, BASE OF NAIL STILL IN.

DISCLAIMER: USING THE VERTICAL DATA IS AT YOUR OWN RISK. SHOULD BE FIELD VERIFIED.

TO REACH STATION FROM INTERSECTION OF IH 35 E AND FRANKFORD IN THE CITY OF CARROLLTON, GO TO THE NORTH EAST CORNER OF THE CROSSOVER BRIDGE OVER IH 35 E.

STATION IS LOCATED AT THE EAST END OF THE BRIDGE OF THE WEST BOUND LANE OF FRANKFORD ROAD. STATION IS ON THE APPROACH SLAB ON THE SHOULDER OF THE ROAD.

**TEXAS DEPARTMENT OF TRANSPORTATION
GPS SATELLITE STATION
HORIZONTAL - VERTICAL CONTROL DATA
UNITS US SURVEY FEET**

STATION INFORMATION

NAME OF STATION: R0610050
SURVEYED FROM: ARL-RRP, DRF1, MASCH, MCKINNEY
DATE: APR. 27, 2000
LOCALITY: SH 121 & BASS PRO DRIVE
COUNTY: DENTON
HIGHWAY: SH 121

STATE PLANE COORDINATES	ORTHO ELEVATION	ADJ. FACTOR SURFACE	TEXAS ZONE
N: 7032188.80167 E: 2417346.78875	Z: 556.192	1.000150630	4202

LATITUDE	LONGITUDE	ELLIP. HEIGHT
32°57'05.00516"N	97°02'11.91239"W	E.H. 467.358

DESCRIPTION OF SATELLITE STATION

STATION IS A ROUND 3 ½" ALUMINUM ALLOY TxDOT DISC SET ATOP A 5/8" PIECE OF STEEL REBAR, FLUSH WITH THE GROUND, AND IS STAMPED R0610050.

DISCLAIMER: USING THE VERTICAL DATA IS AT YOUR OWN RISK. SHOULD BE FIELD VERIFIED.

THE GPS CONTROL POINT IS ON DALLAS MAPSCO 11-A. THE STATION IS IN THE NORTHEAST QUADRANT OF IH 635 AND SH 121. SEE DENTON COUNTY FIELD BOOK PAGE 27 FOR A DETAIL SKETCH OF THE GPS CONTROL POINT.

STATION IS LOCATED AT THE NORTHEAST INTERSECTION OF SH 121, BASS PRO DRIVE AND IH 635 WEST BOUND. STATION IS 90' WEST FROM AN OVERHEAD SIGN BRIDGE. STATION IS 9' NORTH OF THE EDGE OF PAVEMENT, AND 50' EAST OF A LIGHT POLE ON THE RAMP TO BASS PRO DRIVE.

**TEXAS DEPARTMENT OF TRANSPORTATION
GPS SATELLITE STATION
HORIZONTAL - VERTICAL CONTROL DATA
UNITS US SURVEY FEET**

STATION INFORMATION

NAME OF STATION: R0610040
SURVEYED FROM: ARL-RRP, DRF1, MASCH, MCKINNEY
DATE: DEC. 2, 2000
LOCALITY:
COUNTY: DENTON
HIGHWAY: SH 121

STATE PLANE COORDINATES	ORTHO ELEVATION	ADJ. FACTOR SURFACE	TEXAS ZONE
N: 7046037.03979 E: 2425077.43986	Z: 478.320	1.000150630	4202

LATITUDE	LONGITUDE	ELLIP. HEIGHT
32°59'20.94831"N	97°00'38.88637"W	E.H. 389.816

DESCRIPTION OF SATELLITE STATION

STATION IS A ROUND 3 ½" ALUMINUM ALLOY TxDOT DISC SET ATOP A 5/8" PIECE OF STEEL REBAR, FLUSH WITH THE GROUND, AND IS STAMPED R0610040.

DISCLAIMER: USING THE VERTICAL DATA IS AT YOUR OWN RISK. SHOULD BE FIELD VERIFIED.

THIS GPS CONTROL POINT IS ON DALLAS MAPSCO PAGE 1-M. THE STATION IS IN THE SOUTHBOUND SH 121 MERGE OF THE TWO ROADWAYS. STATION IS LOCATED AT THE CENTERLINE OF WESTBOUND SH 121 AND SOUTHBOUND SH 121 BYPASS, 8' EAST OF CONCRETE NOSE AND 5' NORTH OF SH 121 BYPASS AND 6' EAST OF WESTBOUND OF SH 121.

**TEXAS DEPARTMENT OF TRANSPORTATION
GPS SATELLITE STATION
HORIZONTAL - VERTICAL CONTROL DATA
UNITS US SURVEY FEET**

STATION INFORMATION

NAME OF STATION: R0610030
SURVEYED FROM: ARL-RRP, DRF1, MASCH, MCKINNEY
DATE: APR. 27, 2000
LOCALITY: SH 121 & HEBRON PARKWAY
COUNTY: DENTON
HIGHWAY: SH 121

STATE PLANE COORDINATES N: 7058277.98312 E: 2448590.31928	ORTHO ELEVATION Z: 455.681	ADJ. FACTOR SURFACE 1.000150630	TEXAS ZONE 4202
--	--	---	-----------------------------------

LATITUDE 33°01'18.67836"N	LONGITUDE 96°56'00.69595"W	ELLIP. HEIGHT E.H. 368.072
-------------------------------------	--------------------------------------	--------------------------------------

DESCRIPTION OF SATELLITE STATION

STATION IS A ROUND 3 1/2" ALUMINUM ALLOY TxDOT DISC SET ATOP A 5/8" PIECE OF STEEL REBAR, FLUSH WITH THE GROUND, AND IS STAMPED R1300030.

DISCLAIMER: USING THE VERTICAL DATA IS AT YOUR OWN RISK. SHOULD BE FIELD VERIFIED.

THIS GPS CONTROL POINT IS ON DALLAS MAPSCO PAGE 652-V. THE STATION IS IN THE CENTERLINE OF MEDIAN ON HEBRON. STATION IS LOCATED AT THE INTERSECTION OF SH 121 BYPASS AND HEBRON PARKWAY ON THE NORTH BOUND SIDE OF SH 121. IT IS 10' SOUTH FROM THE BACK OF CURB OF THE WEST BOUND LANE OF HEBRON PARKWAY AND 11' NORTH OF THE EAST BOUND LANE OF HEBRON PARKWAY AND 60' EAST FROM THE BACK OF CURB OF SH 121.

**TEXAS DEPARTMENT OF TRANSPORTATION
GPS SATELLITE STATION
HORIZONTAL - VERTICAL CONTROL DATA
UNITS US SURVEY FEET**

STATION INFORMATION

NAME OF STATION: R0610020
SURVEYED FROM: ARL-RRP, DRF1, MASCH, MCKINNEY
DATE: APR. 27, 2000
LOCALITY: SE INTERSECTION OF SH 121 & FM 2281
COUNTY: DENTON
HIGHWAY: SH 121

STATE PLANE COORDINATES	ORTHO ELEVATION	ADJ. FACTOR SURFACE	TEXAS ZONE
N: 7068743.35330 E: 2452934.47864	Z: 536.204	1.000150630	4202

LATITUDE	LONGITUDE	ELLIP. HEIGHT
33°03'01.57914"N	96°55'07.82557"W	E.H. 448.907

DESCRIPTION OF SATELLITE STATION

STATION IS A ROUND 3 ½" ALUMINUM ALLOY TxDOT DISC SET ATOP A 5/8" PIECE OF STEEL REBAR, FLUSH WITH THE GROUND, AND IS STAMPED R1300020.

DISCLAIMER: USING THE VERTICAL DATA IS AT YOUR OWN RISK. SHOULD BE FIELD VERIFIED.

THIS GPS CONTROL POINT IS ON DALLAS MAPSCO PAGE 553-Z. THE STATION IS IN THE SOUTH R.O.W. LINE OF FM 2281 AND SH 121. STATION IS LOCATED AT THE SOUTHEAST CORNER OF SH 121 BYPASS AND FM 2281. IT IS 39' SOUTH OF BACK OF CURB AND 30' SOUTHEAST.

**TEXAS DEPARTMENT OF TRANSPORTATION
GPS SATELLITE STATION
HORIZONTAL - VERTICAL CONTROL DATA
UNITS US SURVEY FEET**

STATION INFORMATION

NAME OF STATION: R0610010
SURVEYED FROM: ARLINGTON, DISTRICT-1, MCKINNEY BASE
DATE: APR. 27, 2000
LOCALITY: COLLIN, DENTON COUNTY LINE
COUNTY: DENTON
HIGHWAY: SH 121

STATE PLANE COORDINATES	ORTHO ELEVATION	ADJ. FACTOR SURFACE	TEXAS ZONE
N: 7082491.89811 E: 2477173.91208	Z: 683.168	1.000150630	4202

LATITUDE	LONGITUDE	ELLIP. HEIGHT
33°05'13.90511"N	96°50'20.50112"W	E.H. 597.028

DESCRIPTION OF SATELLITE STATION

STATION IS A ROUND 3 ½" ALUMINUM ALLOY TxDOT DISC SET ATOP A 5/8" PIECE OF STEEL REBAR, FLUSH WITH THE GROUND, AND IS STAMPED R0610010.

DISCLAIMER: USING THE VERTICAL DATA IS AT YOUR OWN RISK. SHOULD BE FIELD VERIFIED.

THE GPS CONTROL POINT IS ON DALLAS COUNTY MAPSCO PAGE 555-K. THE STATION IS IN THE NORTH R.O.W. LINE OF LEGACY DRIVE AND SH 121. 1500' EAST OF THE COUNTY LINE (DENTON/COLLIN).

**TEXAS DEPARTMENT OF TRANSPORTATION
GPS SATELLITE STATION
HORIZONTAL - VERTICAL CONTROL DATA
UNITS US SURVEY FEET**

STATION INFORMATION

NAME OF STATION: D0570231
SURVEYED FROM: DALLAS RRP, ARLINGTON RRP
DATE: JUN. 13, 2001
LOCALITY: CHALFONT PL. & SH 289(PRESTON RD.)
COUNTY: DALLAS
HIGHWAY: SH 289

STATE PLANE COORDINATES	ORTHO ELEVATION	ADJ. FACTOR SURFACE	TEXAS ZONE
N: 7039164.96908 E: 2488551.69513	Z: 589.696	1.000136506	4202

LATITUDE	LONGITUDE	ELLIP. HEIGHT
32°58'03.43447"N	96°48'14.99831"W	E.H. 503.399

DESCRIPTION OF SATELLITE STATION

STATION IS A ROUND 3 ½" ALUMINUM ALLOY TxDOT DISC SET ATOP A 5/8" PIECE OF STEEL REBAR, FLUSH WITH THE GROUND, AND IS STAMPED D0570231.

DISCLAIMER: USING THE VERTICAL DATA IS AT YOUR OWN RISK. SHOULD BE FIELD VERIFIED.

THE GPS CONTROL POINT IS ON DALLAS MAPSCO 5-T. THE STATION IS LOCATED AT THE INTERSECTION OF CHALFONT PLACE AND SH 289 (PRESTON RD.) AT THE NORTHEAST CORNER OF INTERSECTION.

**TEXAS DEPARTMENT OF TRANSPORTATION
GPS SATELLITE STATION
HORIZONTAL - VERTICAL CONTROL DATA
UNITS US SURVEY FEET**

STATION INFORMATION

NAME OF STATION: D0570101
SURVEYED FROM: DALLAS DIST REF-1, , ARLINGTON RRP
DATE: MAR. 16, 2001
LOCALITY: IH 35 E AND BELT LINE ROAD
COUNTY: DALLAS
HIGHWAY: IH 35 E

STATE PLANE COORDINATES	ORTHO ELEVATION	ADJ. FACTOR SURFACE	TEXAS ZONE
N: 7033531.87287 E: 2456328.25623	Z: 447.343	1.000136506	4202

LATITUDE	LONGITUDE	ELLIP. HEIGHT
32°57'12.68750"N	96°54'34.21774"W	E.H. 359.758

DESCRIPTION OF SATELLITE STATION

STATION IS A ROUND 3 ½" ALUMINUM ALLOY TxDOT DISC SET ATOP A 5/8" PIECE OF STEEL REBAR, FLUSH WITH THE GROUND, AND IS STAMPED D0570101

DISCLAIMER: USING THE VERTICAL DATA IS AT YOUR OWN RISK. SHOULD BE FIELD VERIFIED.

THIS GPS CONTROL POINT IS ON DALLAS MAPSCO PAGE 12-B. THE STATION IS LOCATED AT THE INTERSECTION OF IH 35E AND BELT LINE ROAD, IN THE CITY OF CARROLLTON. STATION IS THE SOUTHEAST QUADRANT OF THIS LOCATION. STATION IS 9' SOUTH OF THE BACK OF CURB BELT LINE ROAD, 21' EAST OF THE EAST RAIL OF THE RAIL ROAD TRACK RUNNING NORTHEAST. STATION IS 11' WEST OF A DRIVEWAY EDGE OF PAVEMENT TO A PARKING LOT. NEXT TO THE STATION IS A 4' WHITE FIBERGLASS WITNESS POST WITH TxDOT SIGN.

**TEXAS DEPARTMENT OF TRANSPORTATION
GPS SATELLITE STATION
HORIZONTAL - VERTICAL CONTROL DATA
UNITS US SURVEY FEET**

STATION INFORMATION

NAME OF STATION: D0570022
SURVEYED FROM: DALLAS RRP, ARLINGTON RRP
DATE: FEB. 26, 2002
LOCALITY: BELT LINE ROAD
COUNTY: DALLAS
HIGHWAY: IH 635

STATE PLANE COORDINATES	ORTHO ELEVATION	ADJ. FACTOR SURFACE	TEXAS ZONE
N: 7022662.74900 E: 2430366.97899	Z: 535.53100	1.000136506	4202

LATITUDE	LONGITUDE	ELLIP. HEIGHT
32°55'28.931240"N	96°59'40.717850"N.	E.H. 447.0290

DESCRIPTION OF SATELLITE STATION

STATION IS A ROUND 3 ½" ALUMINUM ALLOY TxDOT DISC SET ATOP A 5/8" PIECE OF STEEL REBAR, FLUSH WITH THE GROUND, AND IS STAMPED D0570022.

DISCLAIMER: USING THE VERTICAL DATA IS AT YOUR OWN RISK. SHOULD BE FIELD VERIFIED.

THE GPS CONTROL POINT IS ON DALLAS MAPSCO 11A-N. STATION IS AT THE INTERSECTION OF IH 635 AND BELT LINE RD. STATION IS 300' WEST OF THE CENTERLINE BELT LINE RD. ON THE WEST BOUND ENTRANCE RAMP TO IH 635. STATION IS BETWEEN THE WEST BOUND RAMP AND WEST BOUND IH 635.

**TEXAS DEPARTMENT OF TRANSPORTATION
GPS SATELLITE STATION
HORIZONTAL - VERTICAL CONTROL DATA
UNITS US SURVEY FEET**

STATION INFORMATION

NAME OF STATION: D0570012
SURVEYED FROM: DALLAS RRP, ARLINGTON RRP
DATE: FEB. 26, 2002
LOCALITY: LUNA ROAD
COUNTY: DALLAS
HIGHWAY: IH 635

STATE PLANE COORDINATES	ORTHO ELEVATION	ADJ. FACTOR SURFACE	TEXAS ZONE
N: 7015724.36600 E: 2453720.38999	Z: 441.25900	1.000136506	4202

LATITUDE	LONGITUDE	ELLIP. HEIGHT
32°54'16.886630"N	96°55'07.967910"W	E.H. 353.47500

DESCRIPTION OF SATELLITE STATION

STATION IS A ROUND 3 ½" ALUMINUM ALLOY TxDOT DISC SET ATOP A 5/8" PIECE OF STEEL REBAR, FLUSH WITH THE GROUND, AND IS STAMPED D0570012.

DISCLAIMER: USING THE VERTICAL DATA IS AT YOUR OWN RISK. SHOULD BE FIELD VERIFIED.

THE GPS CONTROL POINT IS ON DALLAS MAPSCO 22-A. THE STATION IS LOCATED ON LUNA RD. AT IH 635. STATION IS 1000' SOUTH OF IH 635. STATION IS ON THE CENTERLINE OF LUNA RD. STATION IS JUST PAST THE FIRST BRIDGE. FROM THE END OF THE BRIDGE APPROACH SLAB GO SOUTH 1' STATION IS 11' FROM THE EAST AND WEST CURB LINE OF THE CENTER MEDIAN.

**TEXAS DEPARTMENT OF TRANSPORTATION
GPS SATELLITE STATION
HORIZONTAL - VERTICAL CONTROL DATA
UNITS US SURVEY FEET**

STATION INFORMATION

NAME OF STATION: D0430061
SURVEYED FROM: DALLAS RRP, ARLINGTON RRP
DATE: JUN. 13, 2000
LOCALITY: LORIMAR DRIVE AND SH 289 (PRESTON RD.)
COUNTY: DALLAS
HIGHWAY: SH 289

STATE PLANE COORDINATES	ORTHO ELEVATION	ADJ. FACTOR SURFACE	TEXAS ZONE
N: 7069543.66082 E: 2491137.16083	Z: 682.242	1.000152710	4202

LATITUDE	LONGITUDE	ELLIP. HEIGHT
33°03'03.58361"E	96°47'38.86193"W	E.H. 596.362

DESCRIPTION OF SATELLITE STATION

STATION IS A ROUND 3 ½" ALUMINUM ALLOY TxDOT DISC SET ATOP A 5/8" PIECE OF STEEL REBAR, FLUSH WITH THE GROUND, AND IS STAMPED D0430061.

DISCLAIMER: USING THE VERTICAL DATA IS AT YOUR OWN RISK. SHOULD BE FIELD VERIFIED.

THE GPS CONTROL POINT IS ON DALLAS COUNTY MAPSCO PAGE 5-C. THE STATION IS NORTH OF THE INTERSECTION OF LORIMAR DRIVE AND SH 289.

**TEXAS DEPARTMENT OF TRANSPORTATION
GPS SATELLITE STATION
HORIZONTAL - VERTICAL CONTROL DATA
UNITS US SURVEY FEET**

STATION INFORMATION

NAME OF STATION: RE570095
SURVEYED FROM: ARLINGTON, DISTRICT 1
DATE: JUN. 6, 2000
LOCALITY: IH 635 @ VALLEY VIEW ROAD
COUNTY: DALLAS
HIGHWAY: IH 635

STATE PLANE COORDINATES	ORTHO ELEVATION	ADJ. FACTOR SURFACE	TEXAS ZONE
N: 7023003.29675 E: 2477674.38601	Z: 633.999	1.000136506	4202

LATITUDE	LONGITUDE	ELLIP. HEIGHT
32°55'25.24955"N	96°50'25.66481"W	E.H. 547.170

DESCRIPTION OF SATELLITE STATION

STATION IS A ROUND 3 ½" ALUMINUM ALLOY TxDOT DISC SET ATOP A 5/8" PIECE OF STEEL REBAR, FLUSH WITH THE GROUND, AND IS STAMPED RE570095.

DISCLAIMER: USING THE VERTICAL DATA IS AT YOUR OWN RISK. SHOULD BE FIELD VERIFIED.

TO REACH STATION FROM INTERSECTION OF IH 35 AND IH 635 IN NORTH DALLAS, GO EAST ON IH 635 FOR 3.3 MILES TO THE MIDWAY RD. EXIT. TAKE MIDWAY RD. EXIT, AFTER ABOUT 500', BEAR RIGHT AND JUMP THE CURB AND FOLLOW TOP OF BANK FOR ABOUT 500' TO HIGH POINT OF BANK. STATION LINES UP WITH 2 STREET LIGHT STANDARDS TO THE NORTH, AND IS ON THE NORTH EDGE OF THE BANK.

STATION IS APPROX. 650' WEST OF MIDWAY DR. UNDERPASS, 9' EAST FROM SOUTH EXTENDED CENTER LINE OF STREET PASSING UNDER IH 635, AND 34' NORTH FROM CHAIN LINK FENCE THAT ON THE R.O.W. OF IH 635 SOUTH R.O.W.